

# WALL SHELF UNIT

## CONSTRUCTION PLAN



Difficulty level: **T** | EASY

Completion time: **Less than 4 hours**

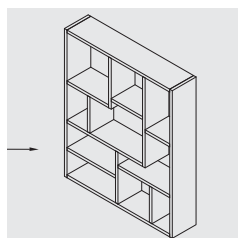
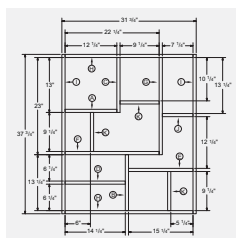
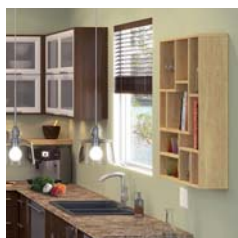

# WALL SHELF UNIT

A wall shelf unit that's fun and original with lots of display space—who could ask for more? With its shelves of all shapes and sizes, this piece will enhance the decor of any room.

Practical and economical, this shelf unit measuring 31 3/4" x 37 3/4" x 7" deep is built from maple-finish plywood. Maple veneer banding is then applied to the edges.



## TOOLS AND MATERIALS NEEDED

### TOOLS

- > Table saw or circular saw with cutting guide
- > Mitre saw
- > Driver drill
- > Pneumatic nailer
- > File
- > Wood chisel
- > Square
- > Level
- > Pencil
- > Measuring tape
- > Iron

### MATERIALS

- > 1 sheet maple-finish plywood, 3/4" x 48" X 96"
- > 1 roll maple-finish edge banding, 13/16"
- > 2 keyhole fastener plates for shelves, with screws
- > 2 - 1 1/2" No.6 screws
- > Anchor dowels
- > 1 1/2" finishing nails for pneumatic nailer
- > Carpenter's glue

## BEFORE ASSEMBLY

### CUTTING LIST

The shelf unit is built entirely from 3/4" maple-finish plywood. Cut lengths of plywood measuring 7" x 96", then cut the various parts according to the dimensions specified below. Take care to clearly identify each part with the corresponding letter. Sand the edges smooth as needed.

Plywood, 3/4" x 48" x 96"

PIECES	QUANTITY	WIDTH (")	LENGTH (")
A SHELF	1	7	12 1/4
B UPRIGHT	1	7	13 1/4
C UPRIGHT	1	7	13
D SHELF	1	7	14 1/4
E SHELF	1	7	15 1/4
F SHELF	1	7	22 1/4
G UPRIGHT	1	7	23
H TOP/BOTTOM	2	7	30 1/4
I SIDE	2	7	37 3/4
J SHELF	1	7	7 1/4
K SHELF	3	7	9 1/4

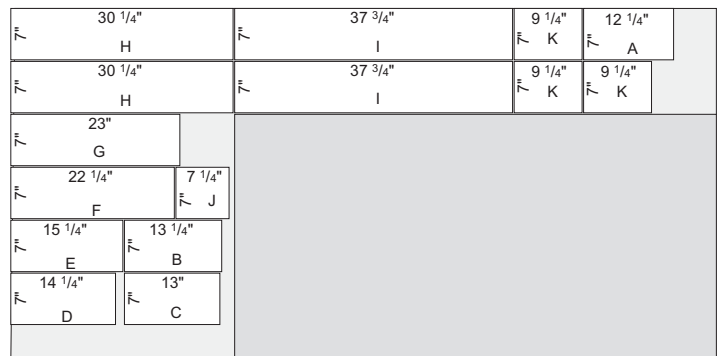

# WALL SHELF UNIT

## BEFORE ASSEMBLY (CONT'D)

### ELEVATIONS

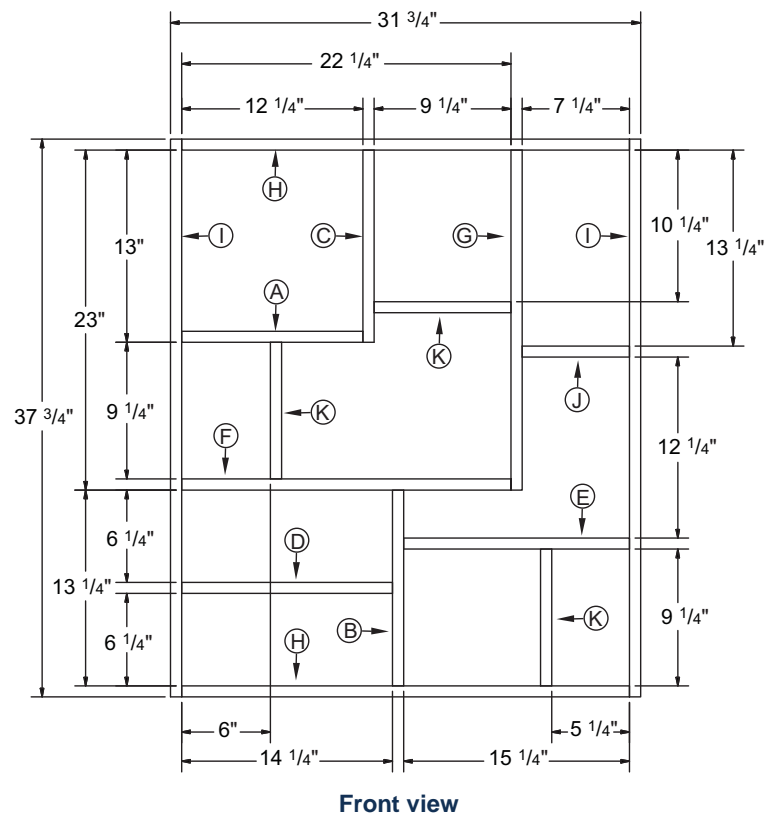

### STEP-BY-STEP

The following instructions refer directly to the elevation presented above, which shows the location of each of the parts. All the parts are glued and nailed together.

### PREPARATION

- 1 Iron the edge banding onto the front of all the parts.
- 2 Remove the excess banding with a file, following the manufacturer's instructions.
- 3 Varnish all the parts.

# WALL SHELF UNIT

## ASSEMBLY

Check the parts for square at each stage of the assembly.

- 4 Make the frame by nailing top and bottom H between uprights I.
- 5 Nail upright C to shelf A, then fasten this assembly to the inside of the frame, in the top left-hand corner.
- 6 Nail upright G to shelf F, then fasten this assembly in the same way as the previous one.
- 7 Nail upright B to the underside of shelf F.
- 8 Install parts D, E, J and K as illustrated above, keeping to the measurements and positions specified in the elevation.
- 9 Fill the holes with a coloured filler to match the maple.
- 10 Varnish the unit.

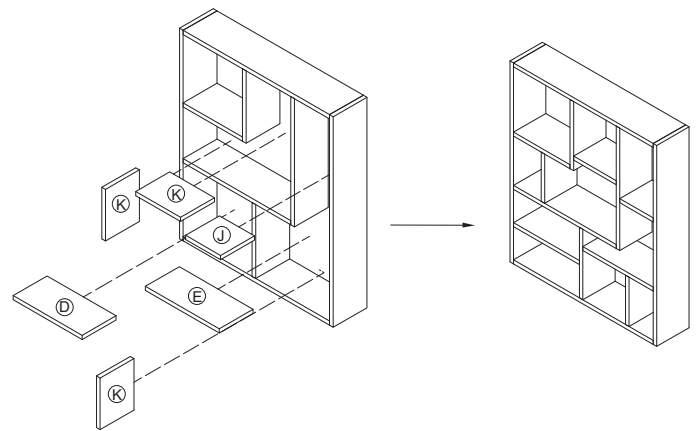
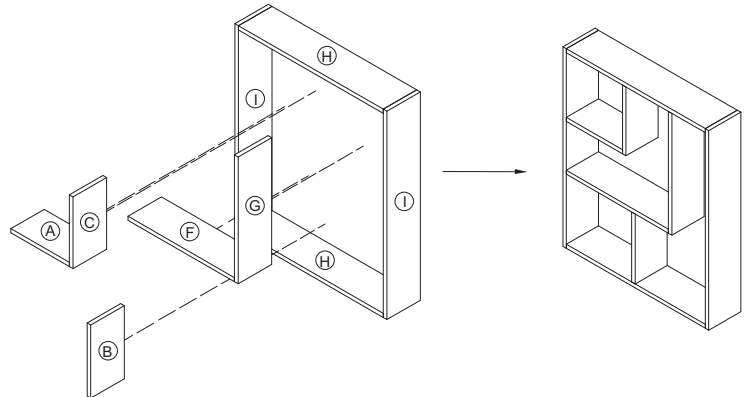

## INSTALLATION

- 11 Screw a fastener plate to the back of each of the uprights I, 3" from their top end. To fit the back of the unit tight to the wall, sink the plates into the back of uprights I instead of simply screwing them to the surface. To do this, draw around the edges of the plates on uprights I and chisel out the wood inside the marks to the same depth as the plates. Then screw in the plates.
- 12 Draw a level line along the wall and make the two marks corresponding to the position of each screw. The screws should be spaced about 31" apart (measure the exact width of the shelf unit, from the centre of one keyhole plate to the other).
- 13 Fasten anchor dowels to the wall at the marks made previously, then insert the 1 1/2" screws into the anchors, leaving the screw head protruding by about 1/4".
- 14 Place the shelves in position, inserting the screw heads into the holes of the keyhole plates. Adjust the depth of the screws as needed, so that the unit fits snug up against the wall.

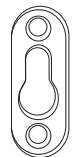

You now have a unique shelf unit that you won't find in any store and, what's more, you built it yourself! Would you like to give it an even more personalized look? Paint the back of the shelves in your room's accent colour.