

OCCASIONAL BENCH

CONSTRUCTION PLAN



Difficulty level: TT | MODERATE

Completion time: 8 hours

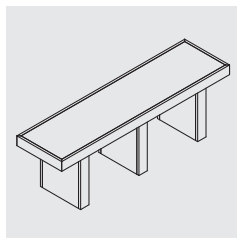
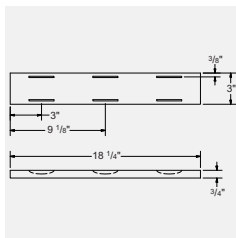

OCCASIONAL BENCH

With its clean, simple lines, this occasional bench will make a stylish addition to your dining room. It is easy to build and goes well with all types of decor, whether modern or more traditional. An elegant way to add extra seating around your table!

This bench measuring 16" x 60" x 19" high is built from solid maple boards and maple-finish plywood. It is assembled almost entirely using wood biscuits, which make invisible joints. Biscuits are small strips of compressed wood that are fitted into slots cut with a special tool known as a biscuit joiner (or plate joiner), which demands a certain level of skill. When the biscuits come into contact with water-based glue applied in the slots, they swell and stay wedged in the slots, holding the structure together.



TOOLS AND MATERIALS NEEDED

TOOLS

- > Mitre saw
- > Table saw
- > Biscuit joiner
- > Driver drill
- > Square
- > Pencil
- > Measuring tape

MATERIALS

- > 1 sheet maple-finish plywood, 3/4" x 48" x 96"
- > 3 maple boards, 1" x 4" x 96"
- > 2 packets No. 10 biscuits, 3/4" x 2 1/8"
- > RONA carpenter's glue
- > 1 1/4" No. 8 wood screws
- > Saman stain – Chocolate No. 119

BEFORE ASSEMBLY

CUTTING LIST

Make sure to clearly identify each part with the corresponding letter. Sand the edges smooth as needed.

Plywood, 3/4" x 48" x 96"

PIECES	QUANTITY	WIDTH (")	LENGTH (")
A TOP OF BENCH	1	14 1/2	58 1/2
B INSIDE OF LEG	6	1 1/2	12 7/8
C SIDE OF LEG – LARGE	6	12 7/8	18 1/4
D BRACKET TO ATTACH LEG	6	2 1/8	14 1/2

Maple boards, 1" x 4" x 96"

PIECES	QUANTITY	WIDTH (")	LENGTH (")
E EDGE OF BENCH TOP – LONG	2	3	60
F EDGE OF BENCH TOP – SHORT	2	3	16
G SIDE OF LEG – SMALL	6	3	18 1/4

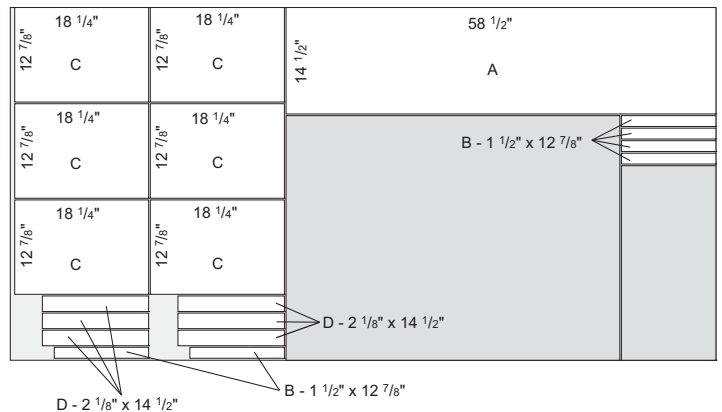

* Parts E, F and G were cut at 3" wide from a 1" x 4" maple board. Cut the ends of parts E and F at a 45° angle.

OCCASIONAL BENCH

STEP-BY-STEP

The bench is assembled using wood biscuits. Clamps are therefore needed to hold the various parts together while the glue dries. The only parts that are not fastened with biscuits are the legs, which are screwed in place.

PREPARATION

- 1 On each part, make the marks showing where to cut the slots for the biscuits. The marks should denote the centre of each slot.

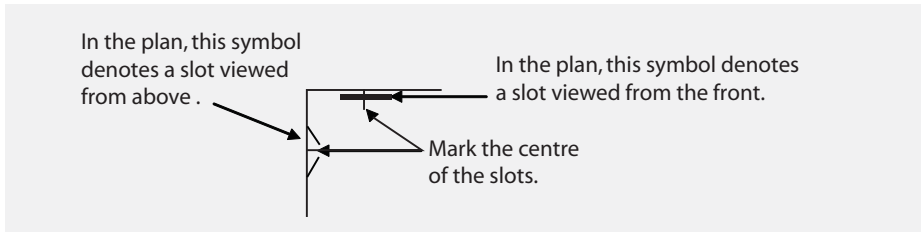

LOCATION OF BISCUITS ON THE VARIOUS PARTS

A – Top of bench

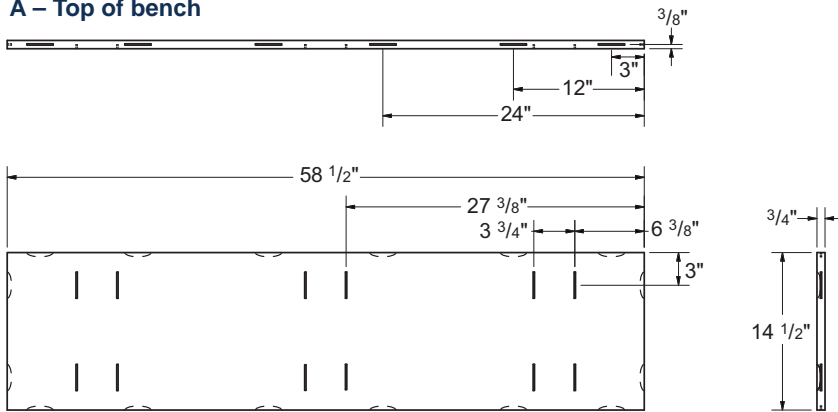

B – Inside of leg

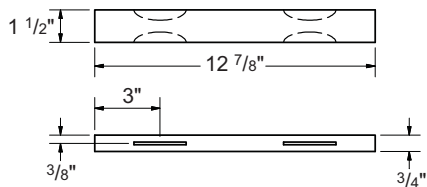

C – Side of leg – large

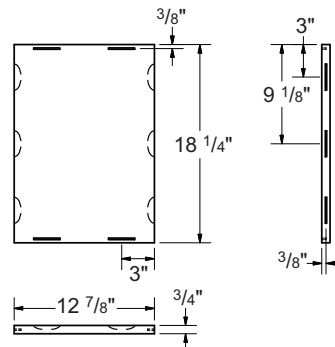

D – Bracket to attach leg

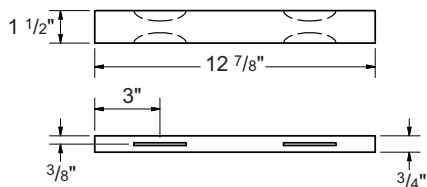

OCCASIONAL BENCH

PREPARATION (CONT'D)

E – Edge of bench top – long

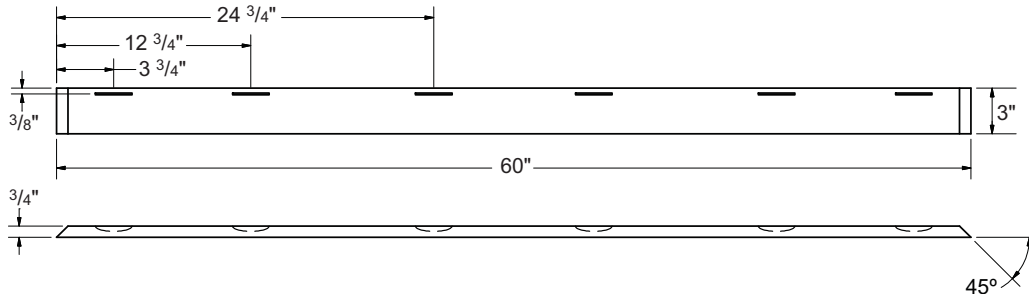

F – Edge of bench top – short

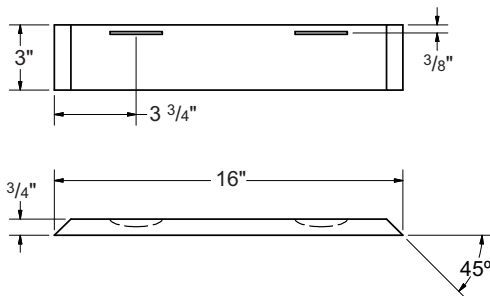

G – Side of leg – small

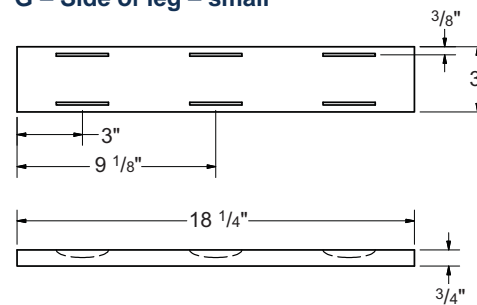

- 2 Cut the slots with the biscuit joiner, aligning the machine's central guide with the marks made on the parts.

ASSEMBLY

Glue must always be applied to the inside of a slot before inserting a biscuit.

LEGS

- 3 Insert biscuits into the slots on one of the large leg sides C.
- 4 Attach two inside leg parts B to the ends of C and fit biscuits into the slots in B.
- 5 Slide the small leg sides G onto the biscuits in C to close up the box that makes the leg.
- 6 Glisser les petits côtés de pattes G sur les biscuits de C pour fermer la boîte qui forme la patte.
- 7 Clamp the parts together while the glue dries.
- 8 Repeat this procedure for the other legs.

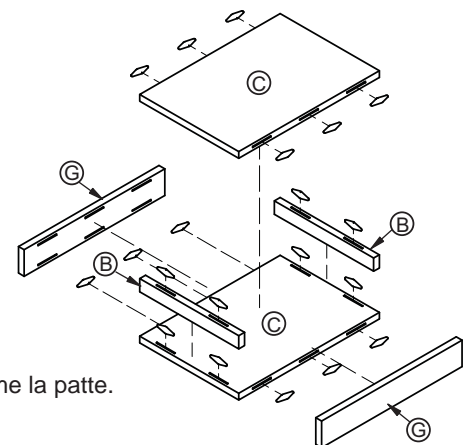

OCCASIONAL BENCH

ASSEMBLY (CONT'D)

TOP OF BENCH

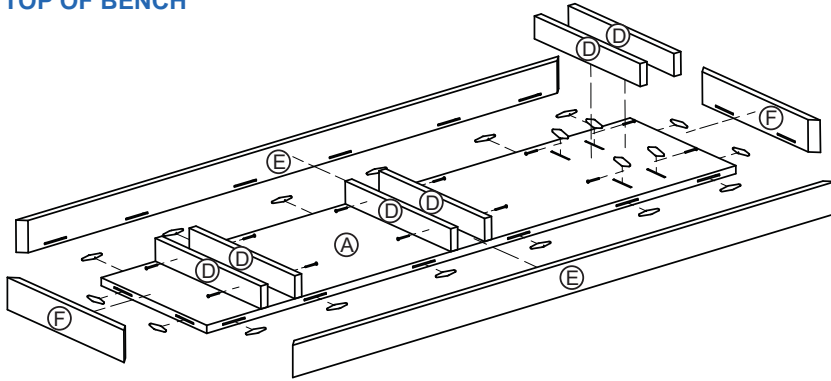

- 9 Insert biscuits into all the slots in the bench top A.
- 10 Fit brackets D onto the biscuits on the flat side of A.
- 11 Affix long edges E and short edges F around the perimeter of A.
- 12 Clamp the parts together while the glue dries.

FASTENING THE LEGS

- 13 Insert the legs between the pairs of brackets.
- 14 Screw the legs in place through the sides of the brackets.

Now you are ready to stain or paint your bench. We recommend staining it, to fully appreciate the texture of the maple wood.

