

# FLOATING SHELF

## CONSTRUCTION PLAN



Difficulty level: **T** | EASY

Completion time: **Less than 3 hours**

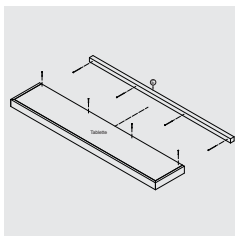
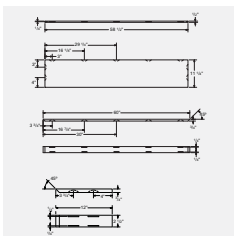

# FLOATING SHELF

As simple as can be, these floating shelves are fabulous in every way. Easy to match with all decor styles, they are sleek and contemporary, and provide useful storage space wherever you need it. Perfect anywhere in the house!

This shelf, measuring 12" x 60" x 2 1/2" thick, is in fact a box built from maple and birch assembled using wood biscuits. Biscuits are small strips of compressed wood that are fitted into slots made with a biscuit joiner. When the biscuits come into contact with water-based glue applied in the slots, they swell and stay wedged in the slots, holding the structure together.



## TOOLS AND MATERIALS NEEDED

### TOOLS

- > Mitre saw
- > Table saw
- > Biscuit joiner
- > Driver drill
- > Square
- > Level
- > Pencil
- > Measuring tape

### MATERIALS

- > 1 sheet Baltic birch, 1/2" x 60" x 60"
- > 1 board maple, 3/4" x 3" x 96"
- > 1 length pine, 1 1/2" x 3" x 96"
- > 1 length spruce, 2" x 4" x 96"
- > 1 packet No. 10 biscuits, 3/4" x 2 1/8"
- > RONA carpenter's glue
- > 1 1/2" No. 6 wood screws
- > 3" No. 8 wood screws

## BEFORE ASSEMBLY

### CUTTING LIST

Make sure to clearly identify each part with the corresponding letter. Sand the edges smooth as needed.

#### Baltic birch, 1/2" x 60" x 60"

PIECES	QUANTITY	WIDTH (")	LENGTH (")
A TOP/BOTTOM OF SHELF	2	11 1/4	58 1/2

#### Maple, 3/4" x 3" x 96"

PIECES	QUANTITY	WIDTH (")	LENGTH (")
B FRONT OF SHELF	1	2 1/2	60
C SIDE OF SHELF	2	2 1/2	12

#### Pine, 1 1/2" x 3" x 96"

PIECES	QUANTITY	WIDTH (")	LENGTH (")
D BRACE	5	2 1/2	9 3/4

#### Spruce, 2" x 4" x 96"

PIECES	QUANTITY	WIDTH (")	LENGTH (")
E BRACKET	1	1 1/2	58 1/2

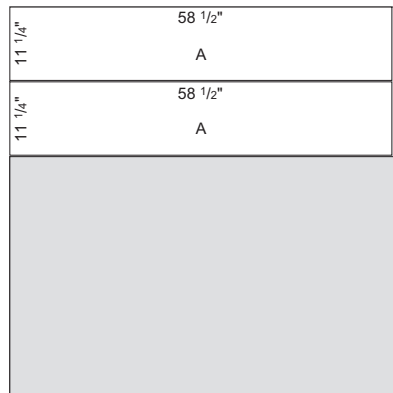

\* Cut the ends of parts B and C at a 45° angle.

# FLOATING SHELF

## STEP-BY-STEP

This shelf is assembled using wood biscuits. Clamps are therefore needed to hold the parts together while the glue dries. The finished shelf is then fastened to the wall with screws.

## PREPARATION

- 1 On each part, make the marks showing where to cut the slots for the biscuits. The marks should denote the centre of each slot.

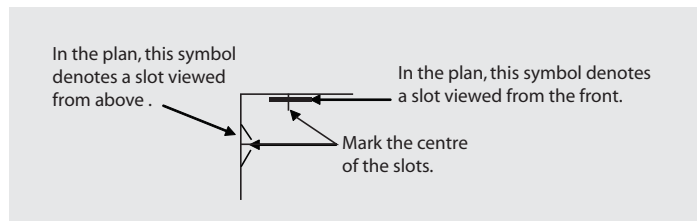

### A – Top/Bottom of shelf

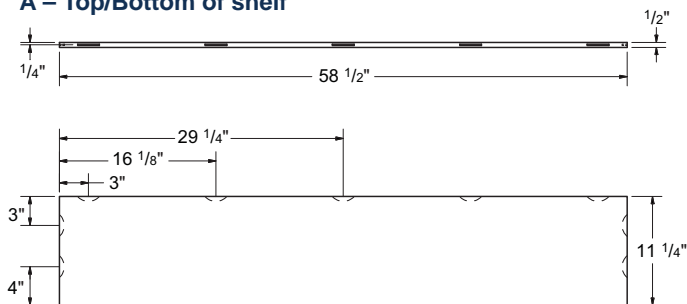

### B – Front of shelf

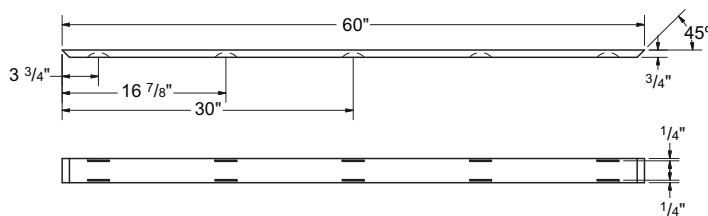

### C – Side of shelf

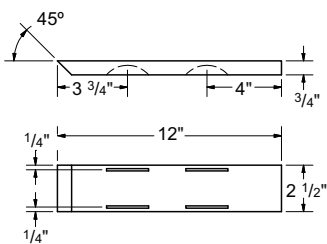

- 2 Cut the slots with the biscuit joiner, aligning the machine's central guide with the marks made on the parts.
- 3 Stain or paint all the parts.

# FLOATING SHELF

## ASSEMBLY

Glue must always be applied to the inside of a slot before inserting a biscuit.

- 4 Glue the five braces D onto one of the birch boards A. Place one brace at each end of A and space the three others evenly in between. The ends of braces D should be flush with the front of board A.
- 5 Apply glue to the top of braces D then lay the other board A on top, so that both boards A are exactly aligned.
- 6 Insert biscuits into all the slots in boards A.
- 7 Apply glue to all the edges of boards A that will be adjoining the front and the sides.
- 8 Attach front B and sides C.
- 9 Hold the structure in place with clamps and put some heavy objects on the top board A to ensure that the braces stay in close contact with the boards. Leave the glue to dry.

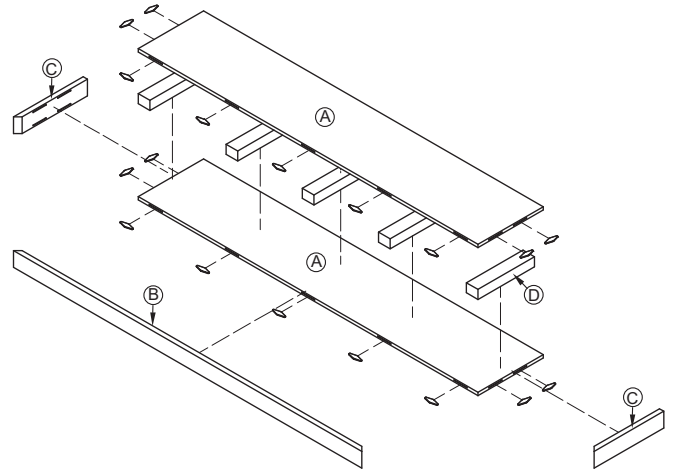

## INSTALLATION

- 10 Screw bracket E to the wall. First make sure the bracket is level, and drill pilot holes in the wood so that it does not split. Screw into the wall studs with 3" screws.
- 11 Slide the shelf onto bracket E until the bracket is fully inserted into the shelf.
- 12 Fasten the shelf to the bracket, screwing through the top of the shelf with 1 1/2" screws. Try to space the screws so that they do not come in contact with those already in the bracket.
- 13 Use filler or drywall compound to conceal the holes, and touch up with paint or stain.

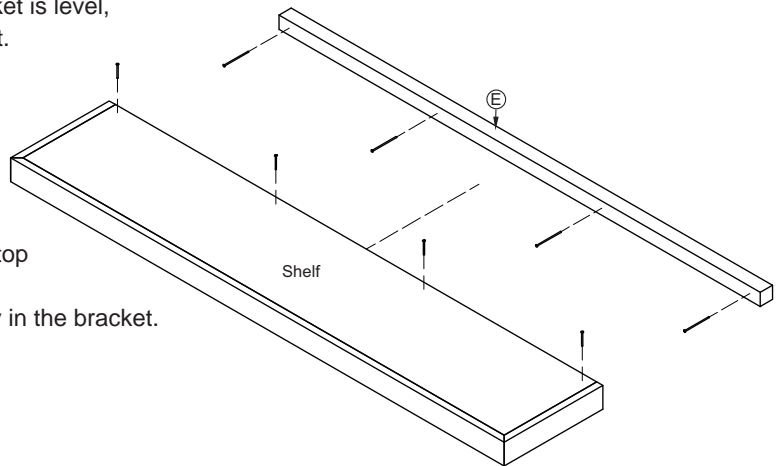

You are now the proud owner of a superb floating shelf—simple to build and easy to fasten to the wall. It is strong enough to hold kitchen accessories, small plant pots and other knick-knacks. Take care, however, not to overload it with heavy objects such as stacks of plates or large flower pots.