

# WINE RACK

## CONSTRUCTION PLAN



Difficulty level: TT | MODERATE

Completion time: 8 hours

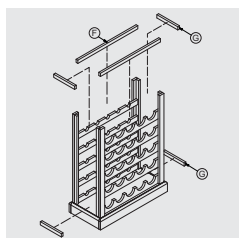
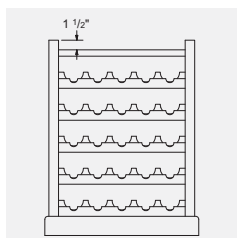

# WINE RACK

Keep your best bottles close to hand with this handy wine rack decorated to match your kitchen. Compact and versatile, it can hold up to 25 bottles and is perfect for filling the space at the end of a counter.

This wine bottle storage rack, measuring 30 1/2" high by 24" wide and 11 3/4" deep, includes a handy removable tray. The rack is made from MDF which is then painted.



## TOOLS AND MATERIALS NEEDED

### TOOLS

- > Mitre saw
- > Table saw
- > Router
- > Drill
- > Hole saw with 3" and 1 1/2" blades
- > Pneumatic nailer
- > Pencil
- > Measuring tape

### MATERIALS

- > 1 sheet MDF, 5/8" x 48" x 48"
- > 1 sheet Masonite, 1/8" x 24" x 48"
- > 1 length pine, 1" x 3" x 96"
- > 1 1/2" No. 8 screws
- > 18-gauge 1" finishing nails for nailer
- > RONA carpenter's glue
- > Richelieu handles

## BEFORE ASSEMBLY

### CUTTING LIST

Take care to clearly identify each part with the corresponding letter. Sand the edges smooth as needed.

#### MDF, 5/8" x 48" x 48"

PIECES	QUANTITY	WIDTH (")	LENGTH (")
A BASE – TOP	1	10	22 3/4
B BASE – LONG SIDE	2	3	24
C BASE – SHORT SIDE	2	3	10
D FRONT/BACK UPRIGHT	4	1 1/2	27 1/2
E SIDE UPRIGHT	4	7/8	27 1/2
H FRONT RACK	5	3	21 1/2
I BACK RACK	5	5	21 1/2
K TRAY – FRONT	2	2 1/2	21 1/2
L TRAY – SIDE	2	2 1/2	7

#### Masonite, 1/8" x 24" x 48"

PIECES	QUANTITY	WIDTH (")	LENGTH (")
J TRAY – BOTTOM	1	7 1/2	20 1/2

#### Pine, 1" x 1" x 96"

PIECES	QUANTITY	WIDTH (")	LENGTH (")
F FRONT/BACK BRACE (OPTIONAL)	2	1	21 1/2
G SIDE BRACE	4	1	7 1/2

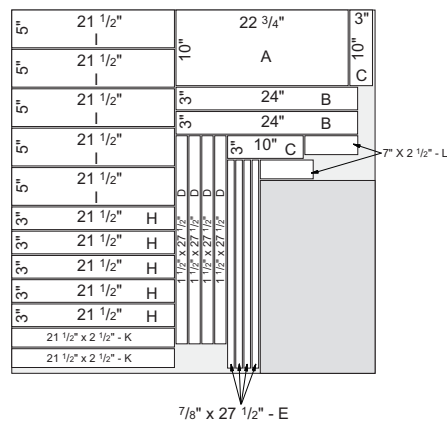

# WINE RACK

## BEFORE ASSEMBLY (CONT'D)

### ELEVATIONS

#### Base

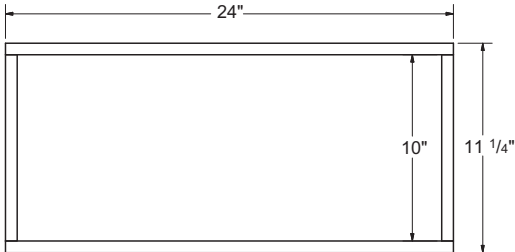

#### Tray

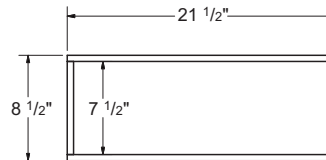

#### Structure

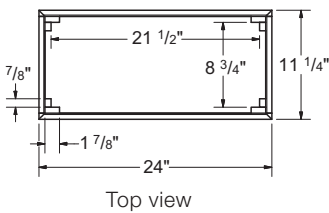
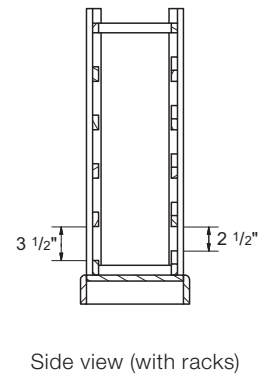
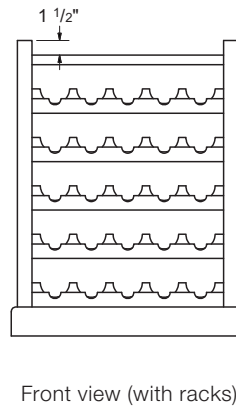
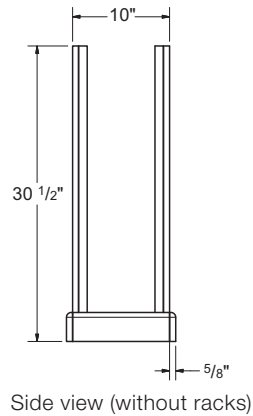
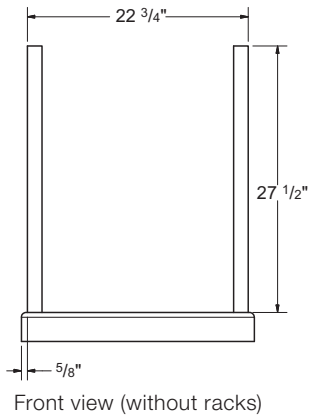

## STEP-BY-STEP

All the pieces of MDF must be glued and nailed together.

### BASE

Glue and nail base top A between sides B and C.

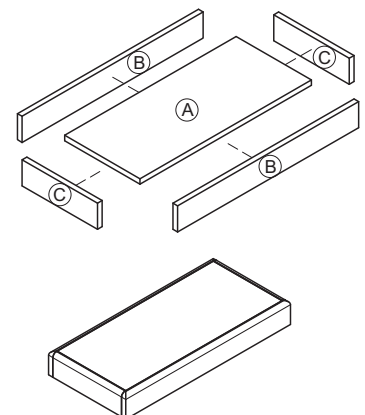

- 1 Glue and nail base top A between sides B and C.
- 2 Round off the edges of the base top with a router (1/2" radius).

# WINE RACK

## STEP-BY-STEP (CONT'D)

### STRUCTURE

The uprights are made from two strips of MDF assembled at right angles and nailed to the base from underneath.

- 3 Make four uprights by gluing and nailing uprights E onto uprights D. The parts should be at right angles to each other, and the edge of E should be flush with that of D.

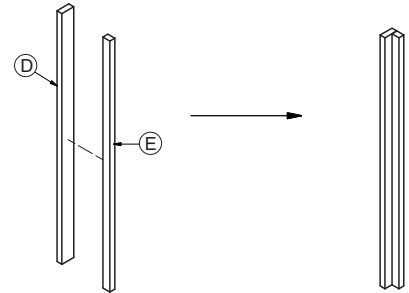

- 4 Fasten the uprights to the four corners of the base by nailing them from underneath. The uprights should be  $\frac{5}{8}$ " from the edges of the base.

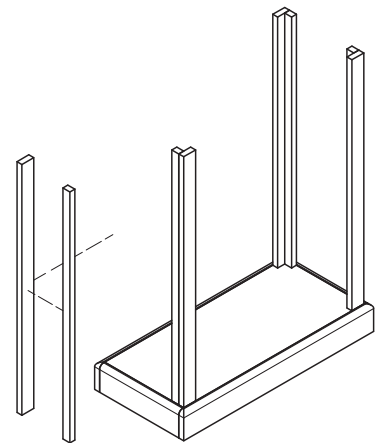
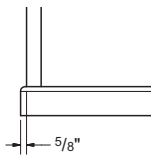

### RACKS AND BRACES

The racks are made by sawing holes in lengths of MDF and then cutting along the exact centre of the holes.

- 5 Draw a line lengthwise along the exact centre of front racks H and back racks I.
- 6 Along the line on each of the racks H and I, make marks at  $3 \frac{1}{4}$ ", 7",  $10 \frac{3}{4}$ ",  $14 \frac{1}{2}$ " and  $18 \frac{1}{4}$ ".
- 7 Saw five holes in racks H with a  $1 \frac{1}{4}$ " cutter and five holes in racks I with a 3" cutter, centering the hole cutters on the marks made previously.
- 8 Cut racks H and I along the centre, lengthwise. Each half thus obtained makes one side of a bottle rack, to support either the bottom end of a bottle or its neck. There will be one rack H and one rack I left over, which you will not need to use.
- 9 Glue and nail front racks H between the uprights, resting the first rack on the base, then positioning the others every  $3 \frac{1}{2}$ ".
- 10 Fasten back racks I in the same way as the front racks, but this time spacing them every  $2 \frac{1}{2}$ ".

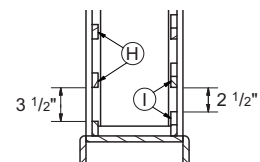

# WINE RACK

## STEP-BY-STEP (CONT'D)

- 11** Insert braces F and G inside the uprights. Bottom braces G should rest on the base, and the top braces should be placed 1 1/2" from the top end of the uprights. Glue and screw in place.

\* Those parts are optional and won't affect the stability of the rack.

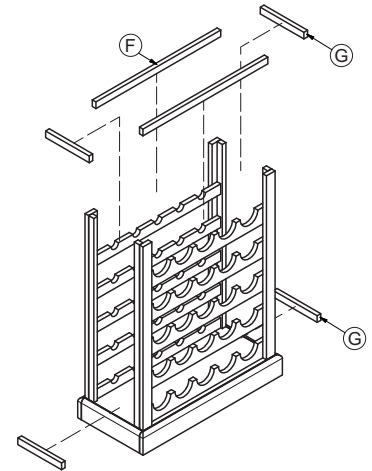
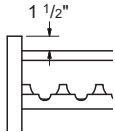

## TRAY

Grooves need to be made along the lower edges of the sides and fronts of the tray, in order to slide in the tray bottom.

- 12** On the table saw, make a groove 1/4" deep and 1/8" wide, 1/2" from the lower edge of parts K and L.
- 13** Fasten one side L between the two fronts K (glue and nail together).

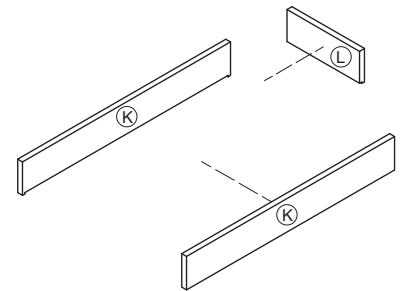

- 14** Slide bottom J into the grooves, then close up the tray frame by fastening the second side L to fronts K.
- 15** Screw the handles onto the tray (bore pilot holes first).
- 16** Add mouldings on the on all four sides for a nicer look. (see picture)

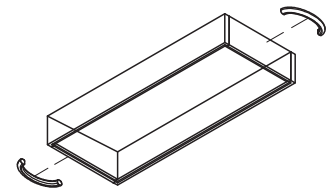

You can also build this project in wood instead of MDF to give it a richer finish.  
All that's left now is to paint your brand new wine rack...and to uncork a good bottle!