

BEDROOM FURNITURE

CONSTRUCTION PLAN



Difficulty level: **T | Easy**

Completion time: **less than 12 hours**

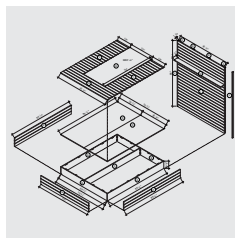
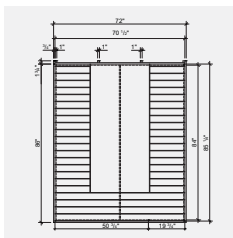

BED BASE AND HEADBOARD

This bedroom set includes a two part bed, the platform and the headboard, and two night stands. The bed measures 72" wide by 87 3/4" long including the headboard. The platform is 11 7/16" high and the headboard measures 86" high. The headboard may include a shelf that can be set at the desired height. Bedside tables measure 22" wide by 15" deep and 23 3/8" high. A slightly amber stain gives all the wood elements an exotic feel that blends well with the olive green colour of the walls.

This bedroom furniture is simple to assemble and does not require any special knowledge. The structure is covered with stained pine boards. The finishing boards are either glued or screwed from the back resulting in a finish that has no visible screws. We recommend staining all parts before assembly.

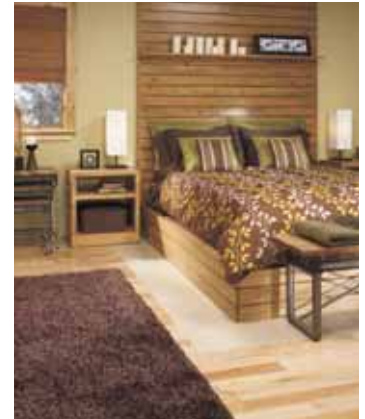

TOOLS AND MATERIALS NEEDED

TOOLS

- > Circular saw or mitre saw
- > Bench saw
- > Drill-screwdriver
- > Measuring tape
- > Square
- > Pencil

MATERIALS

- > 3 sheets of plywood, 48" x 96" x 5/8"
- > 1 sheet of MDF, 48" x 96" x 3/4"
- > 56 boards of pine, 1" x 4" x 96"
- > 1 1/4" No. 6 screws
- > 5/8" No. 8 screws
- > Brackets, 1" x 1" x 1 3/4"
- > Wood glue (carpenter's glue)
- > WATCO® Danish Oil, "Medium Walnut" colour

BEFORE ASSEMBLY

CUTTING LIST

Clearly identify each piece with the corresponding letter before the assembly. Sand the surfaces of the cut parts to soften the edges as well as the pine parts, if necessary. Stain the pine parts after they have been cut, but before installing them.

Plywood, 5/8" x 48" x 96"

PIECES	QUANTITY	WIDTH (")	LENGTH (")
A BED SIDES	2	9 1/2	85 1/4
B BED BACK / FRONT	2	9 1/2	69 1/4
C BED STIFFENER	1	9 1/2	84
D BED TOP	2	85 1/4	35 1/4

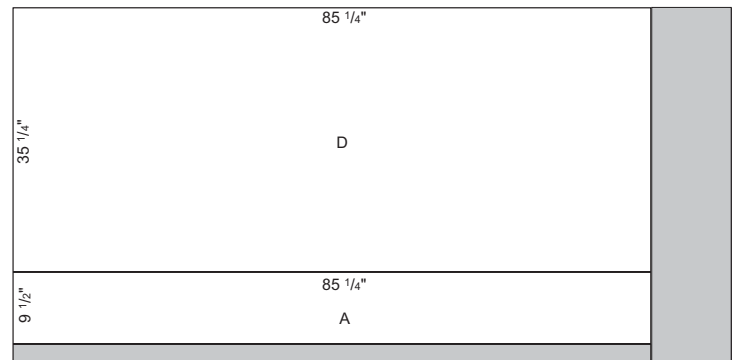

BED BASE AND HEADBOARD

BEFORE ASSEMBLY CONT'D

MDF, 3/4" x 48" x 96"

PIECES	QUANTITY	WIDTH (")	LENGTH (")
E BED TOP - FINISH	1	70	32

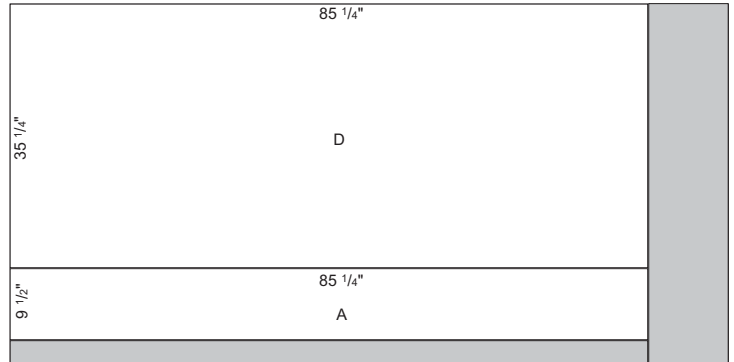

Pine boards, 1" x 4"

PIECES	QUANTITY	WIDTH (")	LENGTH (")
F SIDES - FINISH	6	4	85 1/2
G FOOT - FINISH	3	4	72
H TOP - FINISH	4	4	70 7/16
I TOP - FINISH	38	4	19
J SIDES - HEADBOARD	2	1 3/4	86
K STIFFENER - HEADBOARD	4	1	86
L FRONT - HEADBOARD	23	4	70 1/2
M SHELF - HEADBOARD	1	4	70 1/2

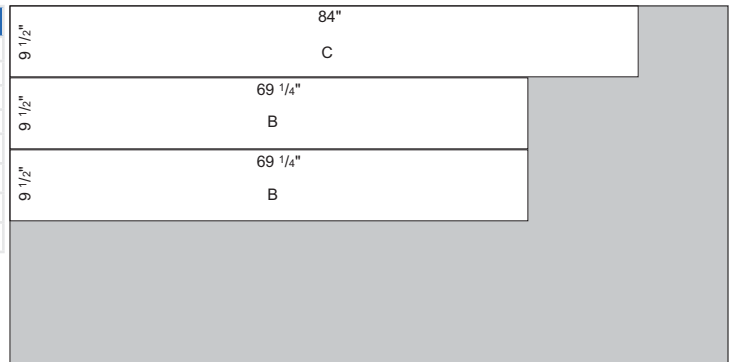

ÉLÉVATIONS

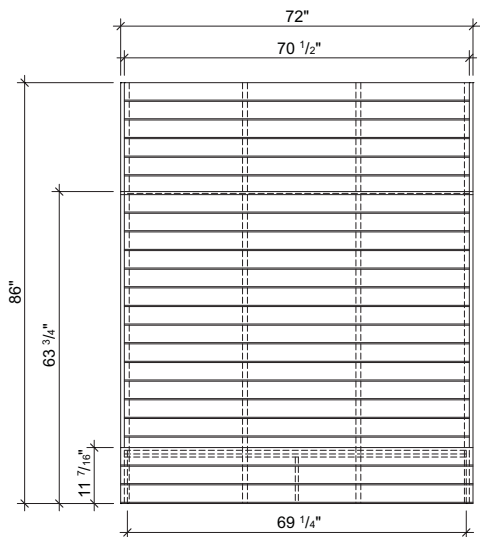

Top view

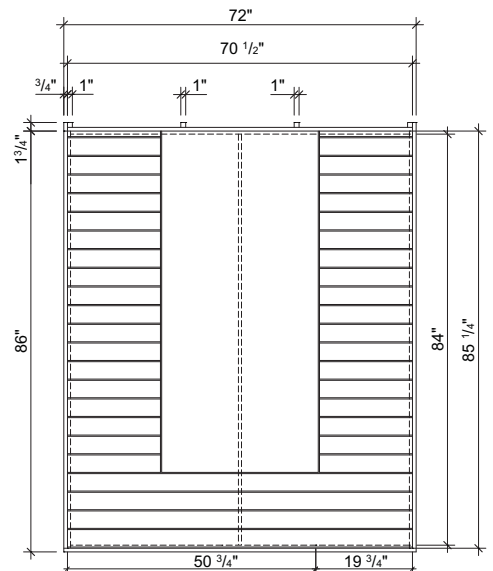

Front view

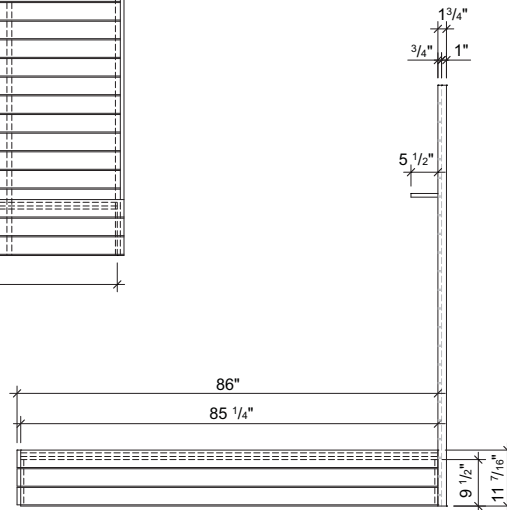

Side view

BED BASE AND HEADBOARD

ASSEMBLY

Some sections of the assembly can be done outside the room, but the weight and dimensions of the finished furniture require that the final assembly of the bed be completed inside the room.

The finishing boards are either glued or screwed from the back of the parts that support them, resulting in a finish that has no visible screws.

- 1 Place the L pine boards side by side on the ground.
- 2 Place a K stiffener perpendicular on the ends of the L boards, and screw, starting from the top of the headboard and progressing downward. Leave a $\frac{1}{4}$ " space between each board (use a long $\frac{1}{4}$ " thick rod as a measure to ensure consistent spacing). Leave a $\frac{3}{4}$ " space where a board will be inserted to make the shelf.
- 3 Ensure that the previous assembly is square, then screw the two K stiffeners 23" from the stiffeners on the ends.
- 4 Screw the J parts to each side of the headboard from the back of the K parts.
- 5 Anchor the headboard to the wall by screwing it to the K stiffeners (insert the screw between two L boards). Screw to cross studs with 2" screws.
- 6 Insert the M shelf in the $\frac{3}{4}$ " space previously planned for it.

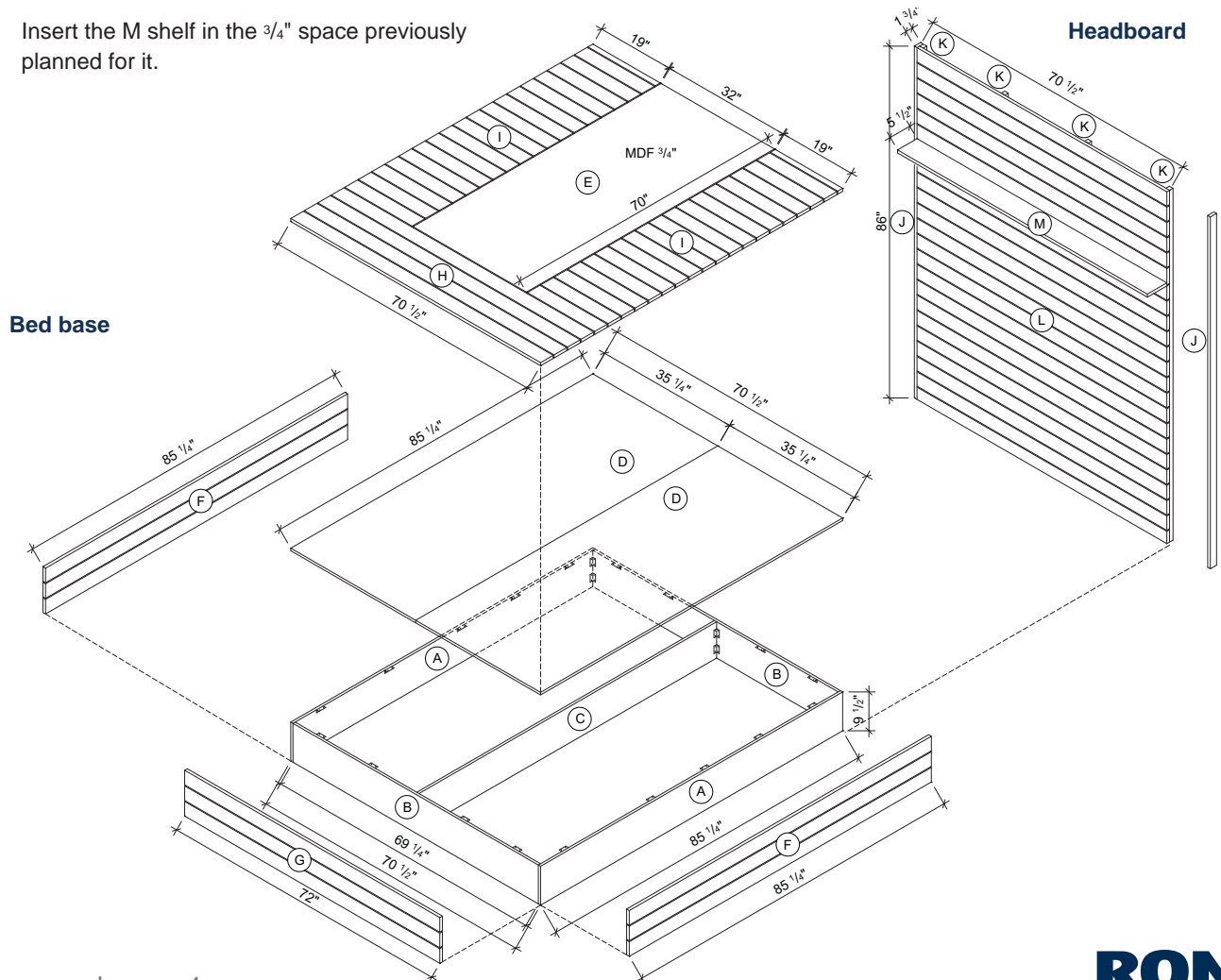

BED BASE AND HEADBOARD

ASSEMBLY (CONT'D)

- 7 Place scraps of pine boards on the floor (ex: scraps from the boards used for the headboard), on an area equivalent to the area of both D parts. The work surface should be perfectly flat.
- 8 Place the D parts side by side on the scraps, which are designed to elevate the D parts by $\frac{3}{4}$ " during assembly. This elevation is necessary for the finishing. Note: In the illustration, the D parts are placed on the base, to better show how they fit together.
- 9 Assemble the bed base by inserting the B parts between the A parts and attaching them with brackets ($\frac{5}{8}$ " screws).
- 10 Insert part C between the B parts, exactly in the center, and attach with brackets.
- 11 The contours of the base should be flush with the edge of the D parts. Assemble with brackets ($\frac{5}{8}$ " screws).

THE BASE FINISH

- 12 Screw, from the inside, the first row of pine boards F and G to parts A and B, with the $1\frac{1}{4}$ " screws. This is where the elevation is needed: By laying the edges of the planks of the first row on the ground, the row covers the $\frac{3}{4}$ " space left by the elevation, and forms a sort of "box" around the platform, once the base is turned over (in its final position).
- 13 Begin the installation of the third row of boards, which should be flush with the edges of A and B.
- 14 Lastly, centre and screw the second board between the first and third.
- 15 Turn over the base by avoiding its edges touching the floor, as this may damage the finishing board. Ask for help for this maneuver.

- 16 Apply glue on the H and I boards and place them as shown in the illustration, spacing them $\frac{1}{4}$ " from each other.
- 17 Apply glue on the E panel and place it in the space that is not occupied by the boards, employing a slight twisting motion so that the glue sticks properly.
- 18 Put the base in place, in front of the headboard made earlier.

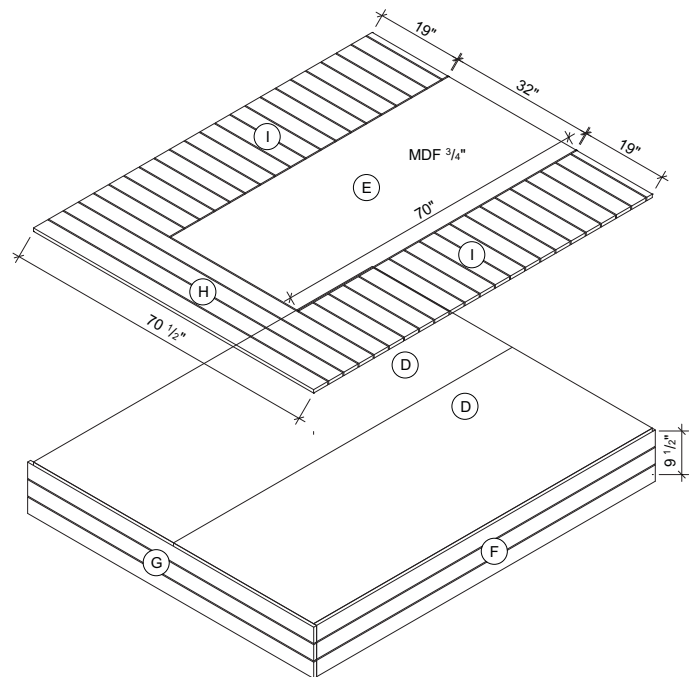

BEDSIDE TABLES

TOOLS AND MATERIALS NEEDED FOR TWO TABLES

TOOLS

- > Circular saw or mitre saw
- > Bench saw
- > Drill-screwdriver
- > Measuring tape
- > Square
- > Pencil

MATERIALS

- > 1 sheet of plywood, 48" x 96" x 5/8"
- > 9 boards of pine, 1" x 4" x 96"
- > 1 1/4" No 6 screws
- > 5/8" No 8 screws
- > Wood glue (carpenter's glue)
- > WATCO® Danish Oil, "Medium Walnut" colour



BEFORE ASSEMBLY

CUTTING LIST FOR TWO TABLES

Plywood, 5/8" x 48" x 96"

PIECES	QTY	TOTAL QTY	WIDTH (")	LENGTH (")
N SIDES	2	4	14 1/4	22 1/4
O TOP	1	2	20 1/2	14 1/4
P BOTTOM / SHELF	2	4	19 1/4	13 5/8
Q C.P.	1	2	14 1/4	3 9/16
X BACK	1	2	19 1/4	22 1/4

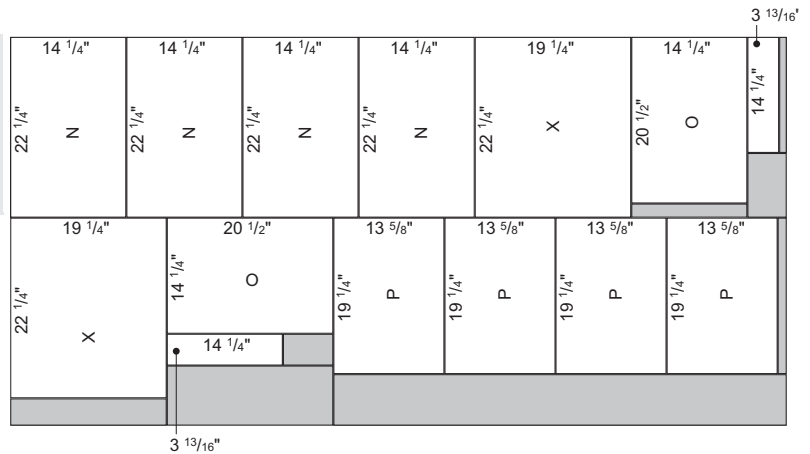

Pine, 1" x 4"

PIECES	QTY	TOTAL QTY	WIDTH (")	LENGTH (")	ANGLE (°)
R SIDES	12	24	4	14 1/4	
S TOP	4	8	4	22	
T FRONT	1	2	1 1/2	22	
U FRONT	2	4	1 1/2	19 13/16	45
V FRONT	1	2	1 1/2	19	45
W FRONT	1	2	3 9/16	22	

Parts T, U, V and W are made from pine 1" x 4", that was split lengthwise, and the edges have been sanded to smooth them. The two ends of T and one end of U should be cut at a 45° angle.

Stain all parts (pine and plywood) after they have been cut, but before installing them.

BEDSIDE TABLES

BEFORE ASSEMBLY CONT'D

ELEVATIONS

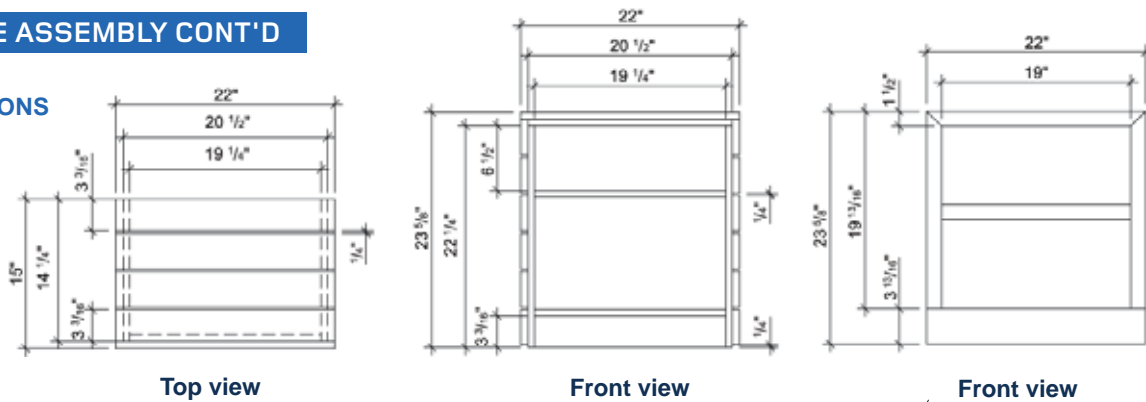

ASSEMBLY

Overview

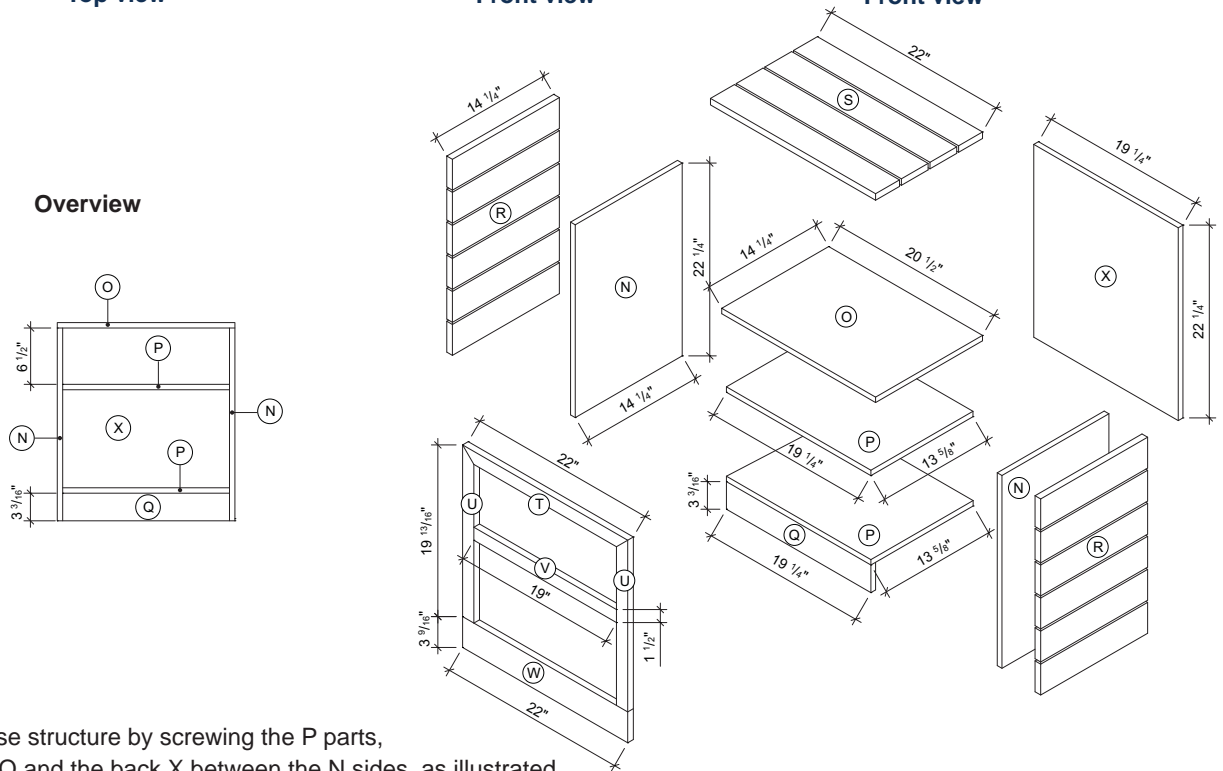

STRUCTURE

- 19 Build the base structure by screwing the P parts, the toe-kick Q and the back X between the N sides, as illustrated.
- 20 Screw the O top to the N parts.

FINISH

- 21 Glue the S parts on top of O, leaving 1/4" between each board. Apply glue to the center of the parts, to avoid overflow on each side. Let the glue dry.
- 22 Glue the R parts on one side of N, leaving 1/4" between each board. Let the glue dry, and then repeat on the other N side.
- 23 Lay the bedside table on its back, then glue the T, U, V and W trims on the front. Let the glue dry.

A nice-looking room, a soothing ambience and a restful sleep. This is what you'll get with this home made furniture!

