



HUGO & BORG

C A B I N E T M A K E R S

YOUR HOME - YOUR STYLE

THE QUALITY CABINETRY PEOPLE

We call ourselves cabinet makers, but at Hugo&Borg we like to think we do more than just make cabinets, we make kitchen dreams come true. Our exciting, ready-to-install collection has it all — and it's all exclusively available at Lowe's.



QUICK SHIP

We'll ship within 2 weeks from ordering. That's less than half the industry's standard lead time.



LIMITED LIFETIME WARRANTY

Great quality and durability guaranteed — we make our cabinets and doors to last.



INCREDIBLE VALUE

Everything about Hugo&Borg says quality. It's unusual to find this level of specification and value combined in one brand.



NEED DESIGN HELP?

Don't have time for an in-store appointment?

Want to design from your home?

Connect with our Hugo&Borg design team for our free design service:

Email: info@hugoandborg.ca

Phone: 1.833.283.2877



ONLINE QUICK ESTIMATE TOOL

Our easy-to-use online quick estimate tool makes it fast and fun to visualize your new kitchen. We'll even give you a quick quote!



EXCEPTIONAL SERVICE

Our friendly, knowledgeable team know our kitchens inside out. We're here to help every step of the way.



LET'S MAKE IT HAPPEN

Start browsing our stunning kitchens on the following pages — you're sure to find the perfect one for you!

WE MAKE KITCHEN DESIGN EASY

We like to keep things simple at Hugo&Borg. Our kitchen collection offers a choice of extremely well-considered designs, in just the right combination of cabinet types and size options, so you can visualize your dream kitchen layout with ease.

Here's our most popular layouts — which one is right for you? Or for something a bit different ask our Hugo&Borg design expert.



STRAIGHT

For maximum use of every square inch in small spaces, a one-wall layout keeps everything close to hand.

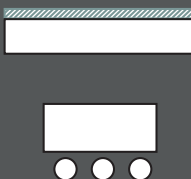

STRAIGHT - ISLAND

A highly modern, sociable layout, great for open plan living, this gives you more food preparation space without compromising style.

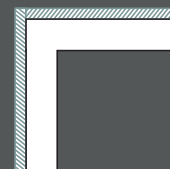

L - SHAPE

A popular layout that makes light work of the 'working triangle' between sink, range and refrigerator. The open floor area allows plenty of room for multiple cooks.

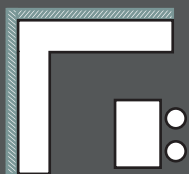

L - SHAPE ISLAND

This winning layout is both practical and sociable. There's plenty of work surface area and you can entertain while you cook!

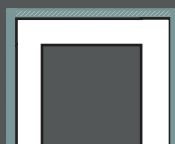

U - SHAPE

The mighty U-shape gives wall-to-wall cabinetry for maximum storage space and work area. A more closed-in layout, check your window position will let in plenty of light.

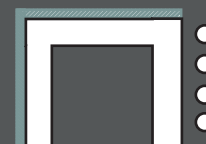

U - SHAPE PENINSULA

The best of both worlds and ideal for open plan living; enjoy plenty of storage space and work area in a more sociable layout.

Start today to visualize what your kitchen will look like.

Or if you prefer to leave it to the experts, just email our Hugo&Borg team direct and we'll create a design for you — it's all part of the service.

1

CHOOSE



2

DESIGN



3

SAVE



4

EMAIL



Quick-click menu - choose layout, measurements, door styles, handles, etc.

On screen reminder of your choices

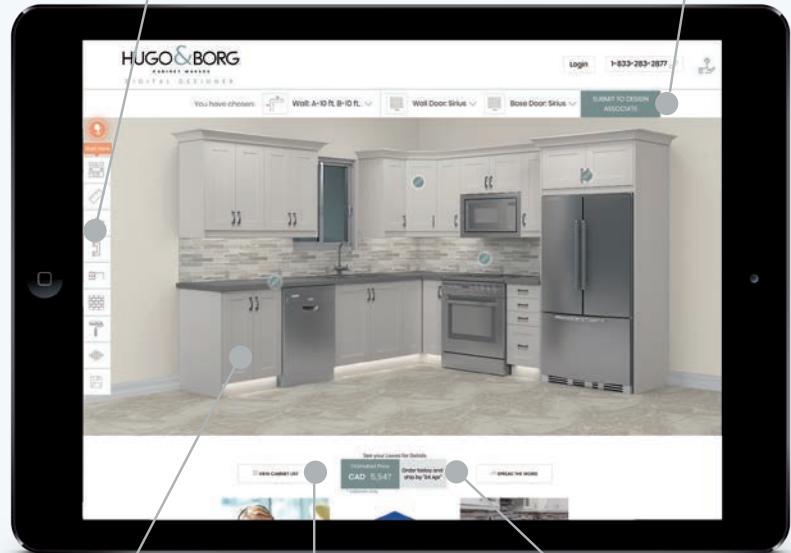

See the image change instantly

Cabinet order list is automatically generated

Immediate price and shipping date estimates

ONLINE

hugoandborg.ca/digital-designer

EMAIL

info@hugoandborg.ca

PHONE

1-833-283-2877



COLLECTIONS



Distinctively rich, this classic hand-painted Slate Grey Shaker style effortlessly radiates a refined warmth and beauty.

BEAUMONT



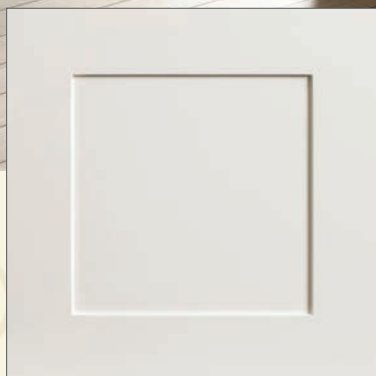

Always in style, this creamy hand-painted Warm White Shaker design creates an inviting cozy space.

JOLIE





Soft and sophisticated, this Light Grey Shaker design is sure to make a style statement and be loved for years to come.

CHARLESBERG

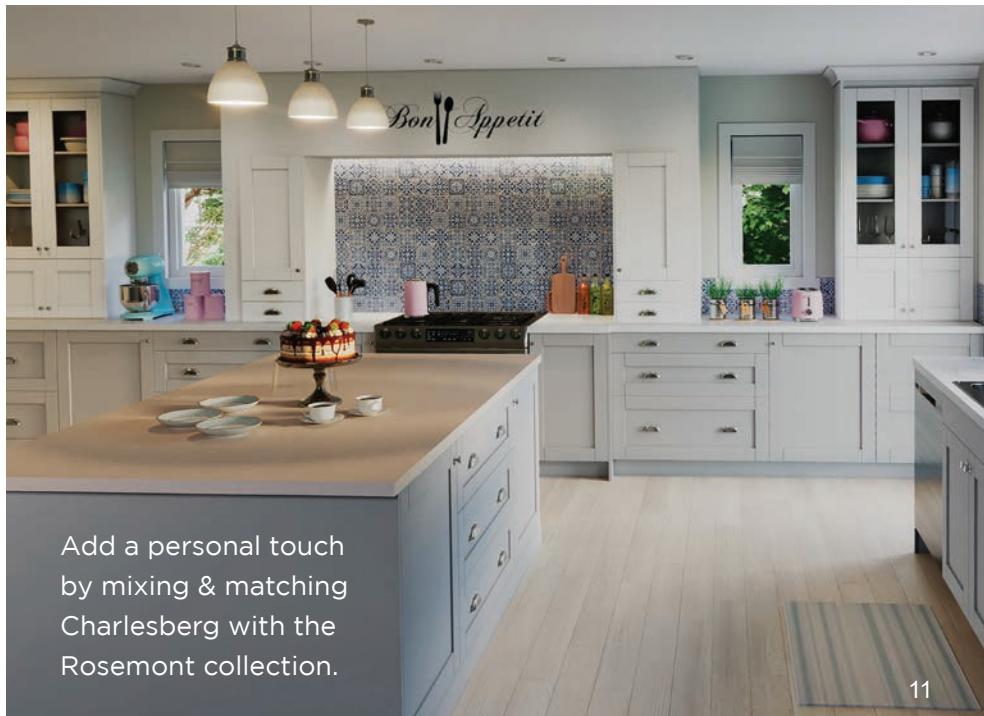

Add a personal touch by mixing & matching Charlesberg with the Rosemont collection.



ROSEMONT

Timeless and elegant, it's easy to contrast or coordinate with this simple, Glacier White Shaker style to create a fresh and bright space.

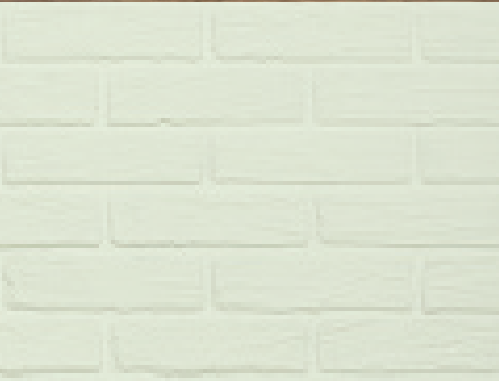



Modern and bright, this Glacier White slab door style is ideal for Minimalist designs and coordinates perfectly with all accent colours.

LASALLE





Jolie

CABINETS FOR THE WHOLE HOME

It's easy to combine Hugo&Borg cabinets to create functional and beautiful storage for your whole home: the mudroom, entertaining spaces, office, laundry room, bathroom and more!





Charlesberg and Lasalle

CREATE A CUSTOM LOOK

Combining door styles adds a dynamic and polished look to every space. Not only does this add visual interest, but opens your décor colour palette even more! Get creative and have fun with your styles!



Beaumont and Jolie

SUPERIOR CONSTRUCTION

High quality is our standard - at a price everyone can afford.

THE DIFFERENCE IS IN THE DETAILS

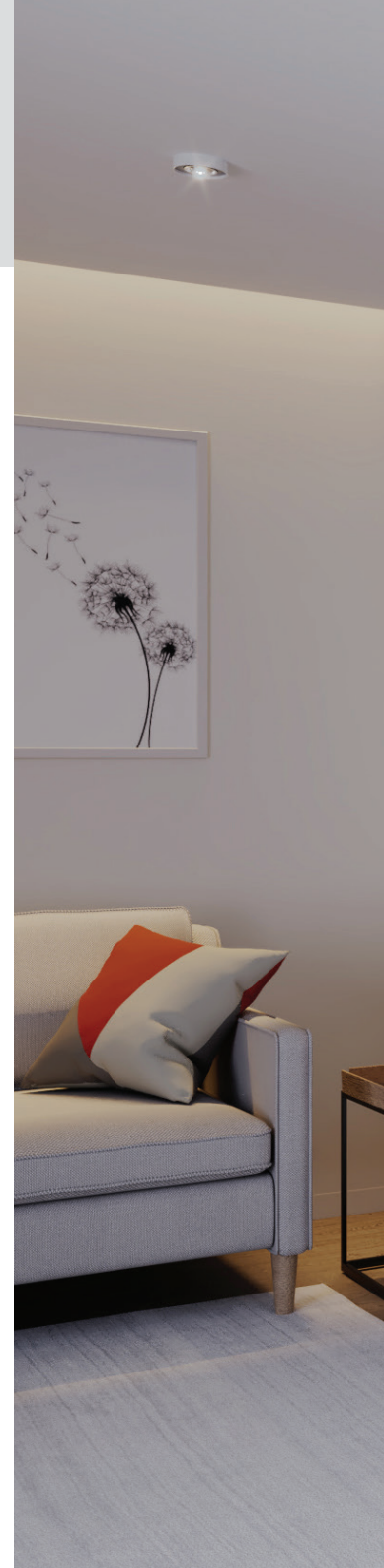
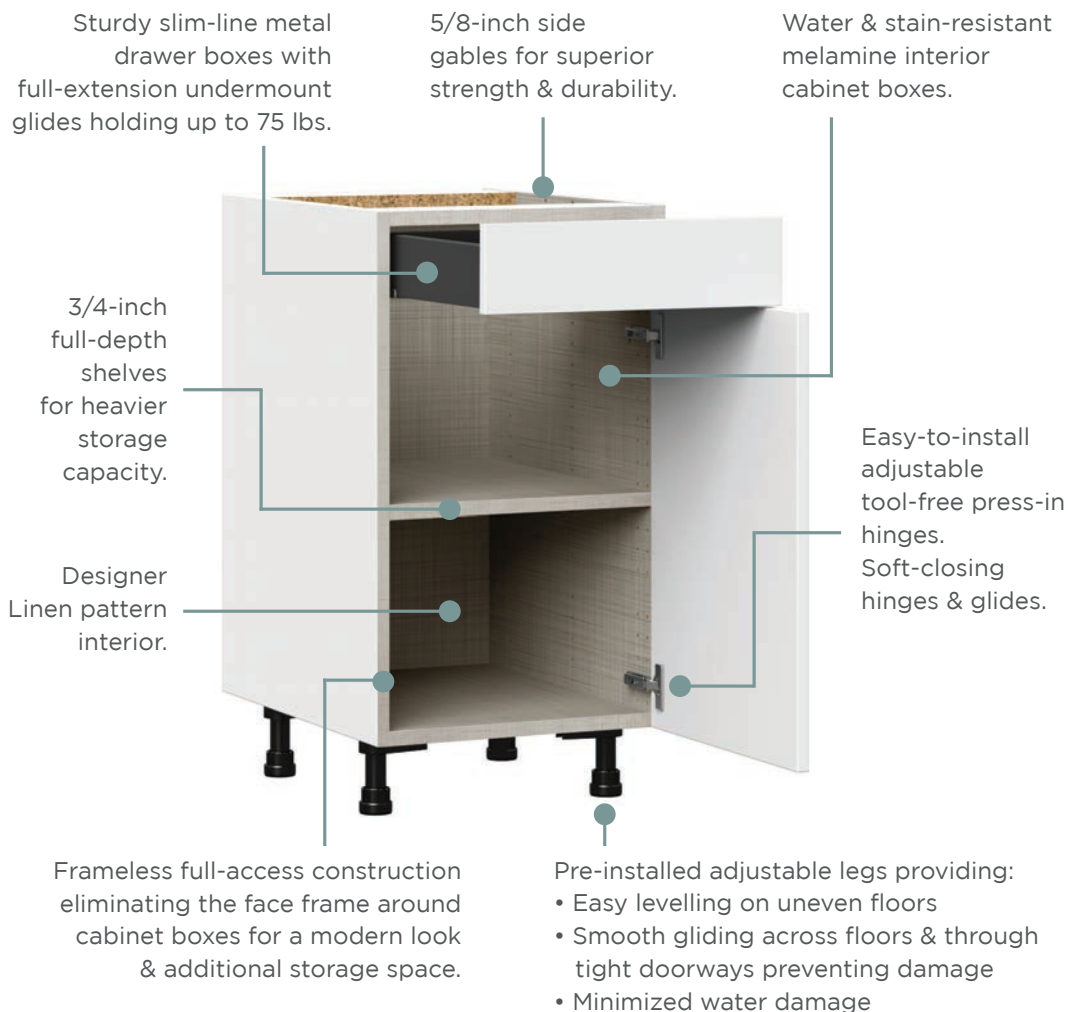





Whether your space is grand or small, combining Hugo&Borg cabinets is easy to create a customized functional and beautiful home.



DOORS & DRAWER FRONTS

Here's our door styles at a glance. Each style comes in a wide choice of door and drawer sizes and are available separately so you can create your ideal layout. **Ask in store or visit hugoandborg.ca for more details.**



BEAUMONT



JOLIE



CHARLESBERG

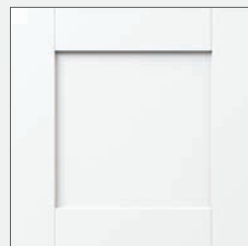

ROSEMONT

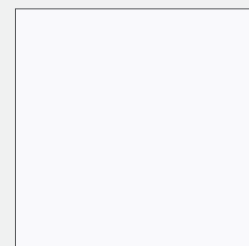

LASALLE

DOOR FRONTS (W X D X H)

15 x 3/4 x 10"	24 x 3/4 x 25"	9 x 3/4 x 35"
18 x 3/4 x 10"	9 x 3/4 x 30"	12 x 3/4 x 35"
15 x 3/4 x 15"	11 x 3/4 x 30"	13 x 3/4 x 35"
18 x 3/4 x 15"	12 x 3/4 x 30"	15 x 3/4 x 35"
15 x 3/4 x 20"	13 x 3/4 x 30"	18 x 3/4 x 35"
18 x 3/4 x 20"	15 x 3/4 x 30"	21 x 3/4 x 35"
24 x 3/4 x 20"	18 x 3/4 x 30"	24 x 3/4 x 35"
15 x 3/4 x 25"	21 x 3/4 x 30"	
18 x 3/4 x 25"	24 x 3/4 x 30"	

DRAWER FRONTS (W X D X H)

15 X 3/4 X 5"	30 X 3/4 X 10"
18 X 3/4 X 5"	36 X 3/4 X 10"
24 X 3/4 X 5"	15 X 3/4 X 15"
30 X 3/4 X 5"	18 X 3/4 X 15"
36 X 3/4 X 5"	24 X 3/4 X 15"
15 X 3/4 X 10"	30 X 3/4 X 15"
18 X 3/4 X 10"	36 X 3/4 X 15"
24 X 3/4 X 10"	

GLASS DOOR FRONTS (W X D X H)

13 X 3/4 X 30"	All glass doors include clear glass with matching frames*.
13 X 3/4 X 35"	
15 X 3/4 X 30"	
15 X 3/4 X 35"	
18 X 3/4 X 30"	
18 X 3/4 X 35"	

*Lasalle glass doors have a Rosemont-style frame.

FINISHING TOUCHES

It's the attention to detail that makes all the difference. Carefully considered decorative touches and well thought-out storage ideas will always remind you why Hugo&Borg was the best decision you ever made.

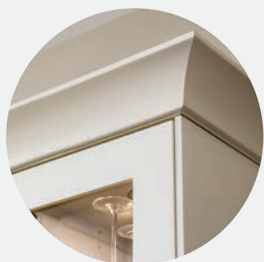

Cove crown moulding
& glass doors



Base moulding



Hidden drawers
/ roll-out trays



Internal glass shelves
/ designer linen interior



Floating shelves

BASE CABINET OPTIONS

Choose from our extensive collection of base cabinets available in all the shapes and sizes you need. These cabinets are 34 1/2" high including legs x 24" deep. Width options are listed with each cabinet.

BASE CABINETS >

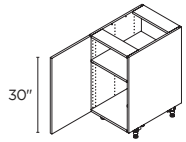

1 DOOR

9" | B9FH(L/R)
12" | B12FH(L/R)
15" | B15FH(L/R)
18" | B18FH(L/R)
21" | B21FH(L/R)
24" | B24FH(L/R)

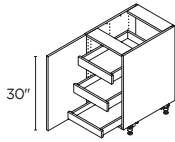

1 DOOR / 3 INNER DRAWERS

15" | B15FHI3(L/R)
18" | B18FHI3(L/R)
24" | B24FHI3(L/R)

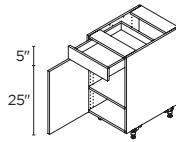

1 DOOR / 1 DRAWER

15" | B15(L/R)
18" | B18(L/R)
24" | B24(L/R)

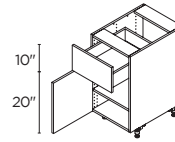

1 DOOR / 1 DRAWER

15" | B15A(L/R)
18" | B18A(L/R)
24" | B24A(L/R)

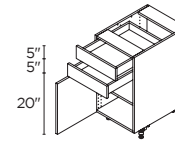

1 DOOR / 2 DRAWERS

15" | B15B(L/R)
18" | B18B(L/R)
24" | B24B(L/R)

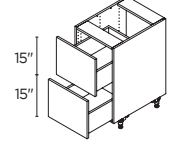

2 DRAWERS

15" | B2D15
18" | B2D18
24" | B2D24
30" | B2D30
36" | B2D36

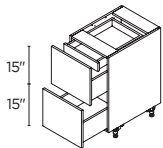

2 DRAWERS / 1 INNER DRAWER

15" | B2D15I1
18" | B2D18I1
24" | B2D24I1
30" | B2D30I1
36" | B2D36I1

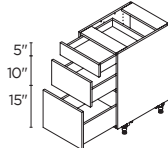

3 DRAWERS

15" | B3D15
18" | B3D18
24" | B3D24
30" | B3D30
36" | B3D36

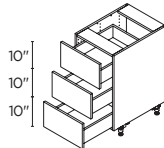

3 DRAWERS

15" | B3DA15
18" | B3DA18
24" | B3DA24
30" | B3DA30
36" | B3DA36

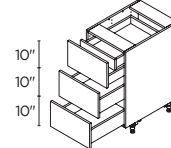

3 DRAWERS / 1 INNER DRAWER

15" | B3DA15I1
18" | B3DA18I1
24" | B3DA24I1
30" | B3DA30I1
36" | B3DA36I1

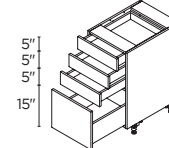

4 DRAWERS

15" | B4D15
18" | B4D18
24" | B4D24
30" | B4D30
36" | B4D36

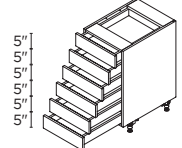

6 DRAWERS

15" | B6D15
18" | B6D18
24" | B6D24
30" | B6D30
36" | B6D36

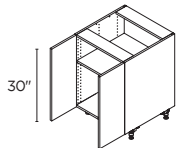

2 DOORS

24" | B24-2FH
30" | B30FH
36" | B36FH

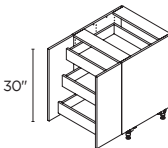

2 DOORS / 3 INNER DRAWERS

24" | B24-2FHI3
30" | B30FHI3
36" | B36FHI3

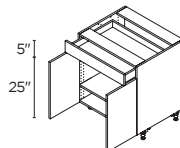

2 DOORS / 1 DRAWER

30" | B30
36" | B36

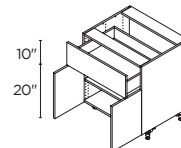

2 DOORS / 1 DRAWER

30" | B30A
36" | B36A

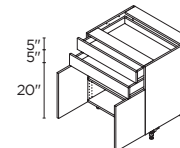

2 DOORS / 2 DRAWERS

30" | B30B
36" | B36B

CORNER CABINETS >

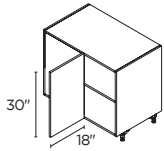

BLIND CORNER WITH SHELF
39" | BBCL39
39" | BBCR39

Min. 42 3/4" doesn't allow for filler / hardware clearance.
Max. 45 3/4" is with 3" filler attached to be flush with door - filler not included.

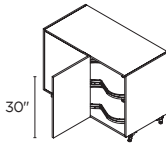
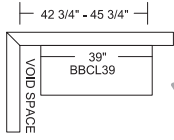

BLIND CORNER WITH PULL-OUT
39" | BBCL39LC
39" | BBCR39LC

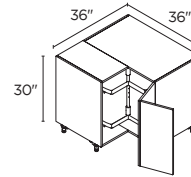
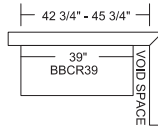

CORNER WITH LAZY SUSAN
36" | BC36LS(L/R)

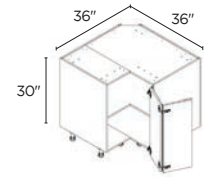

CORNER WITH SHELF
36" | BC36(L/R)

SINK CABINETS >

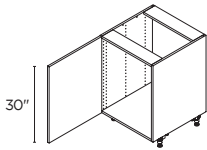

1 DOOR
24" | SB24FH(L/R)

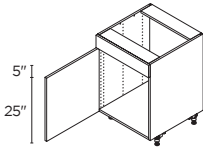

1 DOOR / 1 FIXED FRONT
24" | SB24FF(L/R)

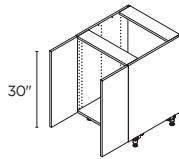

2 DOORS
24" | SB24-2FH
30" | SB30FH
36" | SB36FH

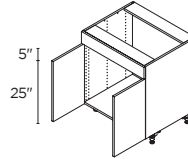

2 DOORS / 1 FIXED FRONT
30" | SB30FF
36" | SB36FF



2 DOORS
30" | SBAS30

A separate drawer front must be ordered to complete.



2 DOORS
36" | SBAS36

WASTE/RECYCLE CABINETS

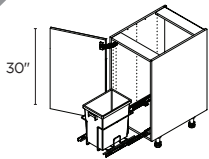

PULL-OUT / 1 DOOR
18" | B18FHPWB(L/R)

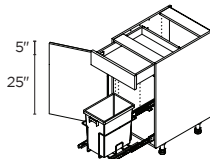

PULL-OUT / 1 DOOR / 1 DRAWER
18" | B18PWB(L/R)

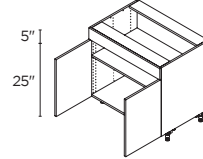

2 DOORS / 1 FIXED FRONT
36" | BCT36FF

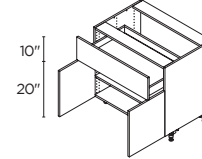

2 DOORS / 1 DRAWER
36" | BCT36A

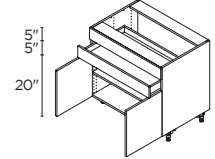

2 DOORS / 1 DRAWER / 1 FIXED FRONT
36" | BCT36BFF

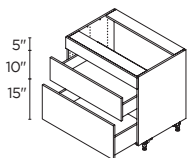

2 DRAWERS / 1 FIXED FRONT
36" | BCT3D36FF

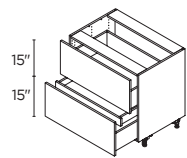

2 DRAWERS / 1 INNER DRAWER
36" | BCT2D36II

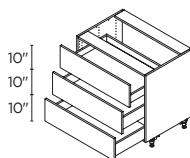

3 DRAWERS
36" | BCT3D36A

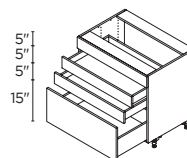

3 DRAWERS / 1 FIXED FRONT
36" | BCT4D36FF

COOKTOP CABINETS >

MICROWAVE CABINET

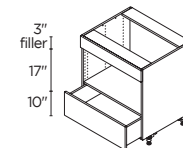

1 DRAWER
30" | BMW30

Cut-out size:
28 1/2" wide x 17" high.
Filler can be cut to adjust height opening 17" to 20".

SHALLOW BASE CABINET OPTIONS

Choose from our extensive collection of shallow base cabinets available in all the shapes and sizes you need. These cabinets are 34 1/2" high including legs x 14" deep. Width options are listed with each cabinet.

SHALLOW BASE CABINETS >

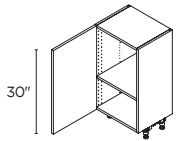

1 DOOR

9" | B914FH(L/R)
12" | B1214FH(L/R)
15" | B1514FH(L/R)
18" | B1814FH(L/R)
21" | B2114FH(L/R)
24" | B2414FH(L/R)

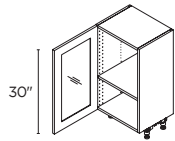

1 GLASS DOOR*

15" | BG1514FH(L/R)
18" | BG1814FH(L/R)

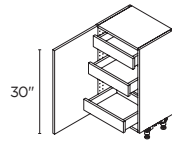

1 DOOR / 3 INNER DRAWERS

15" | B1514FHI3(L/R)
18" | B1814FHI3(L/R)
24" | B2414FHI3(L/R)

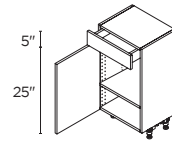

1 DOOR / 1 DRAWER

15" | B1514(L/R)
18" | B1814(L/R)
24" | B2414(L/R)

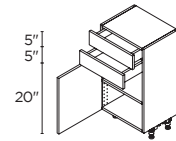

1 DOOR / 2 DRAWERS

15" | B1514B(L/R)
18" | B1814B(L/R)
24" | B2414B(L/R)

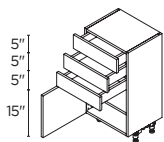

1 DOOR / 3 DRAWERS

15" | B1514C(L/R)
18" | B1814C(L/R)

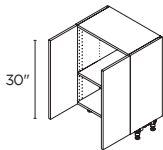

2 DOORS

24" | B2414-2FH
30" | B3014FH
36" | B3614FH

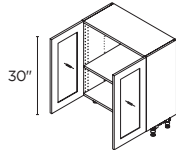

2 GLASS DOORS*

30" | BG3014FH
36" | BG3614FH

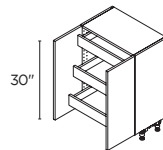

2 DOORS / 3 INNER DRAWERS

24" | B2414-2FHI3

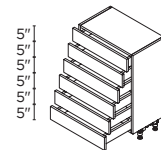

6 DRAWERS

15" | B6D1514
18" | B6D1814
24" | B6D2414

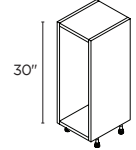

BASE OPEN SHELF

9" | BOS930

BASE WINDOW SEAT >

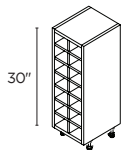

BASE WINE RACK

9" | BWC930

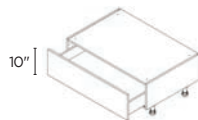

1 DRAWER

30" | BWS3010
36" | BWS3610

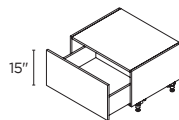

1 DRAWER

30" | BWS3015
36" | BWS3615



*Glass shelves can be purchased separately.

WALL CABINET OPTIONS

Choose from our extensive collection of wall cabinets available in all the shapes and sizes you need.

Our wall and glass door wall cabinets are 14" deep while our deep and corner wall cabinets are 24" deep.

Height and width options are listed with each cabinet.

WALL CABINETS >

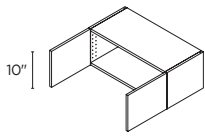

**10" HIGH
2 DOORS**

30" | W3010
36" | W3610

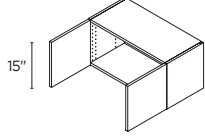

**15" HIGH
2 DOORS**

30" | W3015
36" | W3615

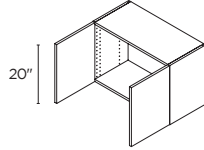

**20" HIGH
2 DOORS**

30" | W3020
36" | W3620

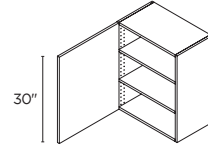

**30" HIGH
1 DOOR**

9" | W930(L/R) 18" | W1830(L/R)
12" | W1230(L/R) 21" | W2130(L/R)
15" | W1530(L/R) 24" | W2430(L/R)

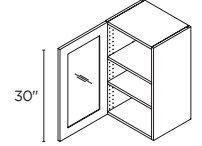

**30" HIGH
1 GLASS DOOR***

15" | WG1530(L/R)
18" | WG1830(L/R)

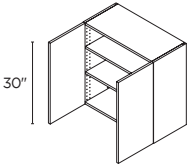

**30" HIGH
2 DOORS**

24" | W2430-2
30" | W3030
36" | W3630

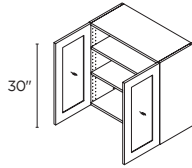

**30" HIGH
2 GLASS DOORS***

30" | WG3030
36" | WG3630

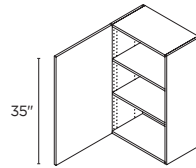

**35" HIGH
1 DOOR**

9" | W935(L/R) 18" | W1835(L/R)
12" | W1235(L/R) 21" | W2135(L/R)
15" | W1535(L/R) 24" | W2435(L/R)

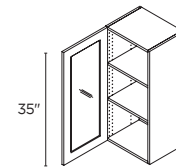

**35" HIGH
1 GLASS DOOR***

15" | WG1535(L/R)
18" | WG1835(L/R)

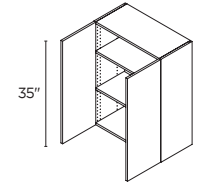

**35" HIGH
2 DOORS**

24" | W2435-2
30" | W3035
36" | W3635

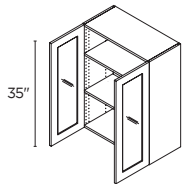

**35" HIGH
2 GLASS DOORS***

30" | WG3035
36" | WG3635

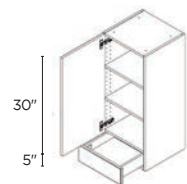

**35" HIGH
1 DOOR / 1 DRAWER**

15" | W1535A(L/R)
18" | W1835A(L/R)
24" | W2435A(L/R)

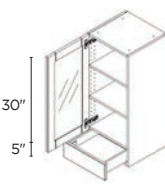

**35" HIGH
1 GLASS DOOR* / 1 DRAWER**

15" | WG1535A(L/R)
18" | WG1835A(L/R)

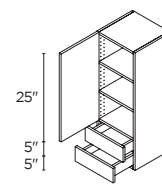

**35" HIGH
1 DOOR / 2 DRAWERS**

15" | W1535B(L/R)
18" | W1835B(L/R)
24" | W2435B(L/R)

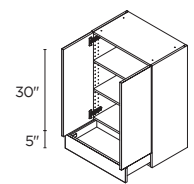

**35" HIGH
2 DOORS /
1 DRAWER**

24" | W2435-2B

*Glass shelves can be purchased separately.

LIFT-UP WALL CABINETS >

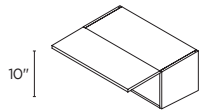

10" HIGH
1 LIFT-UP DOOR
 30" | WLU3010
 36" | WLU3610

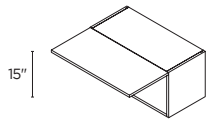

15" HIGH
1 LIFT-UP DOOR
 30" | WLU3015
 36" | WLU3615

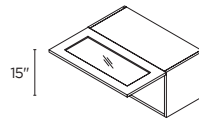

15" HIGH
1 GLASS LIFT-UP DOOR
 30" | WLUG3015

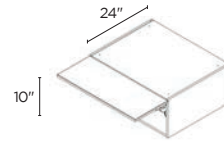

10" HIGH
1 LIFT-UP DOOR
 30" | WLU301024
 36" | WLU361024

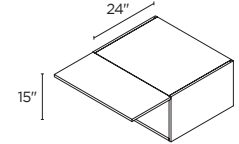

15" HIGH
1 LIFT-UP DOOR
 30" | WLU301524
 36" | WLU361524

CORNER WALL CABINETS >

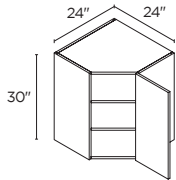

30" HIGH
1 DOOR
 24" | WA2430(L/R)

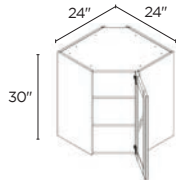

30" HIGH
1 GLASS DOOR*
 24" | WAG2430(L/R)

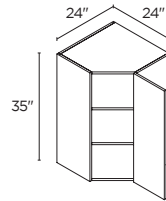

35" HIGH
1 DOOR
 24" | WA2435(L/R)

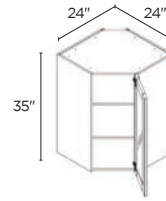

35" HIGH
1 GLASS DOOR*
 24" | WAG2435(L/R)

DEEP WALL CABINETS >

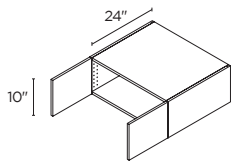

10" HIGH
2 DOORS
 30" | W301024
 36" | W361024

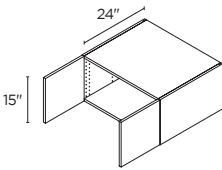

15" HIGH
2 DOORS
 30" | W301524
 36" | W361524

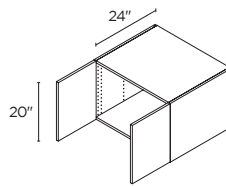

20" HIGH
2 DOORS
 30" | W302024
 36" | W362024

SPECIALTY WALL CABINETS >

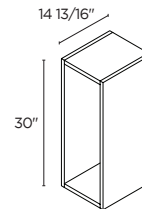

WALL OPEN SHELF
 9" | WOS930

Vertical or horizontal installation.

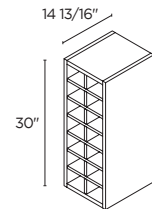

WALL WINE RACK
 9" | WWC930

Vertical or horizontal installation.

*Glass shelves can be purchased separately.

84 1/2" H TALL CABINET OPTIONS

Choose from our extensive collection of tall cabinets available in all the shapes and sizes you need. These cabinets are 24" deep x 84 1/2" high. Width options are listed with each cabinet.

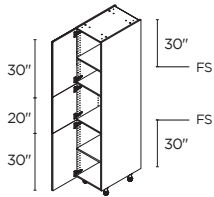

3 DOORS

15" | T152484.5(L/R)
18" | T182484.5(L/R)
24" | T242484.5(L/R)

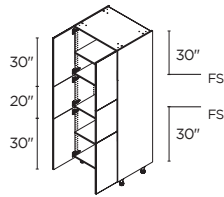

6 DOORS

30" | TB302484.5

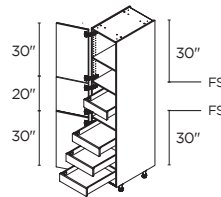

3 DOORS / 4 INNER DRAWERS

15" | T152484.514(L/R)
18" | T182484.514(L/R)
24" | T242484.514(L/R)

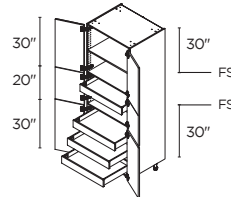

6 DOORS / 4 INNER DRAWERS

30" | T302484.514

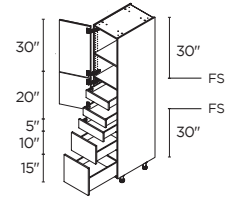

2 DOORS / 3 DRAWERS / 2 INNER DRAWERS

15" | T3D152484.512(L/R)
18" | T3D182484.512(L/R)
24" | T3D242484.512(L/R)

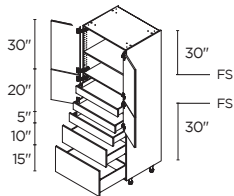

4 DOORS / 3 DRAWERS / 2 INNER DRAWERS

30" | T3D302484.512

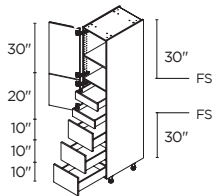

2 DOORS / 3 DRAWERS / 2 INNER DRAWERS

15" | T3DA152484.512(L/R)
18" | T3DA182484.512(L/R)
24" | T3DA242484.512(L/R)

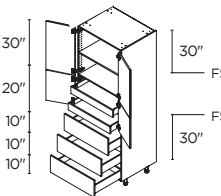

4 DOORS / 3 DRAWERS / 2 INNER DRAWERS

30" | T3DA302484.512

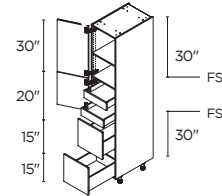

2 DOORS / 2 DRAWERS / 2 INNER DRAWERS

15" | T2D152484.512(L/R)
18" | T2D182484.512(L/R)
24" | T2D242484.512(L/R)

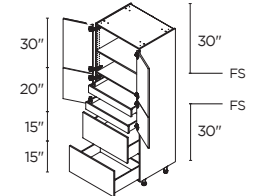

4 DOORS / 2 DRAWERS / 2 INNER DRAWERS

30" | T2D302484.512

84 1/2" H TALL APPLIANCE CABINETS

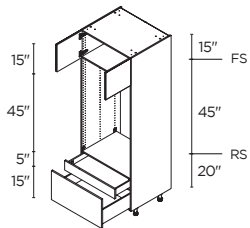

MICRO/WALL OVEN² / 2 DOORS / 2 DRAWERS

30" | TMO2D3084.5

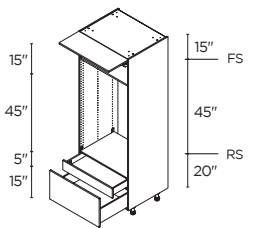

MICRO/WALL OVEN² / 1 LIFT-UP DOOR / 2 DRAWERS

30" | TMOL2D3084.5

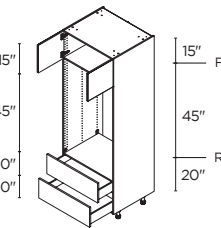

MICRO/WALL OVEN² / 2 DOORS / 2 DRAWERS

30" | TMO2DA3084.5

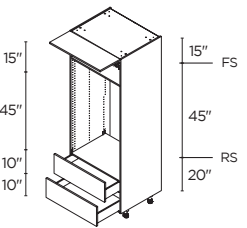

MICRO/WALL OVEN² / 1 LIFT-UP DOOR / 2 DRAWERS

30" | TMOL2DA3084.5

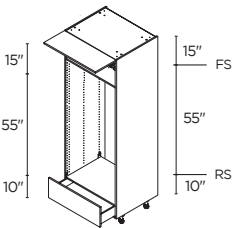

DOUBLE OVEN³ / 1 LIFT-UP DOOR / 1 DRAWER

30" | TDOLA3084.5

RS = Reinforced Shelf, FS = Fixed Shelf. **Appliance cut-out sizes:** (use of a filler is required and must be ordered separately):
¹28 1/2" width x 18 1/2" high. ²28 1/2" width x 43 1/2" high. ³28 1/2" width x 53 1/2" high. ⁴28 1/2" width x 28 1/2" high.

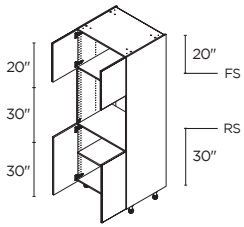

SINGLE OVEN ⁴
4 DOORS
 30" | TO3084.5

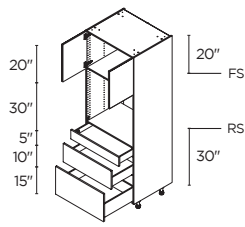

SINGLE OVEN ⁴
2 DOORS /
3 DRAWERS
 30" | TO3D3084.5

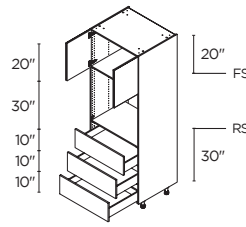

SINGLE OVEN ⁴
2 DOORS /
3 DRAWERS
 30" | TO3DA3084.5

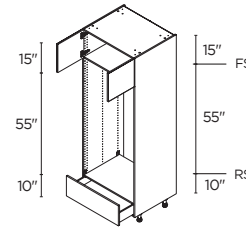

DOUBLE OVEN ³
2 DOORS / 1 DRAWER
 30" | TDOA3084.5

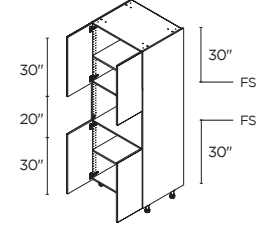

MICROWAVE ¹
4 DOORS
 30" | TM3084.5

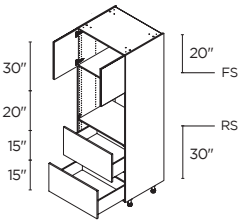

MICROWAVE ¹
2 DOORS /
2 DRAWERS
 30" | TO2D3084.5

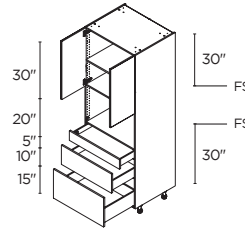

MICROWAVE ¹
2 DOORS /
3 DRAWERS
 30" | TM3D3084.5

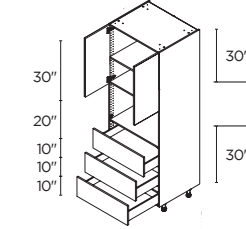

MICROWAVE ¹
2 DOORS /
3 DRAWERS
 30" | TM3DA3084.5

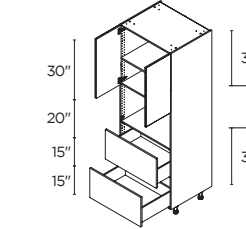

MICROWAVE ¹
2 DOORS /
2 DRAWERS
 30" | TM2D3084.5



RS = Reinforced Shelf, FS = Fixed Shelf. **Appliance cut-out sizes:** (use of a filler is required and must be ordered separately):
¹ 28 1/2" width x 18 1/2" high. ² 28 1/2" width x 43 1/2" high. ³ 28 1/2" width x 53 1/2" high. ⁴ 28 1/2" width x 28 1/2" high.

89 1/2" H TALL CABINET OPTIONS

Choose from our extensive collection of tall cabinets available in all the shapes and sizes you need. These cabinets are 24" deep x 89 1/2" high. Width options are listed with each cabinet.

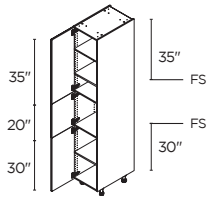

3 DOORS

15" | T152489.5(L/R)
18" | T182489.5(L/R)
24" | T242489.5(L/R)

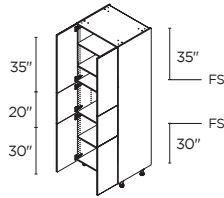

6 DOORS

30" | T302489.5

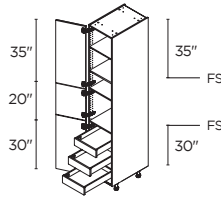

3 DOORS / 3 INNER DRAWERS

15" | T152489.5I3(L/R)
18" | T182489.5I3(L/R)
24" | T242489.5I3(L/R)

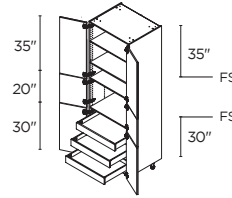

6 DOORS / 3 INNER DRAWERS

30" | T302489.5I3

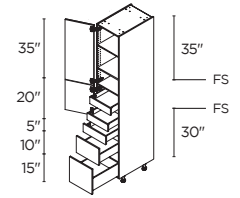

2 DOORS / 3 DRAWERS / 2 INNER DRAWERS

15" | T3D152489.5I2(L/R)
18" | T3D182489.5I2(L/R)
24" | T3D242489.5I2(L/R)

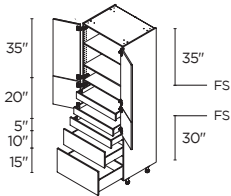

4 DOORS / 3 DRAWERS / 2 INNER DRAWERS

30" | T3D302489.5I2

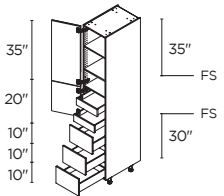

2 DOORS / 3 DRAWERS / 2 INNER DRAWERS

15" | T3DA152489.5I2(L/R)
18" | T3DA182489.5I2(L/R)
24" | T3DA242489.5I2(L/R)

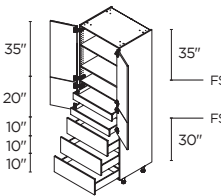

4 DOORS / 3 DRAWERS / 2 INNER DRAWERS

30" | T3DA302489.5I2

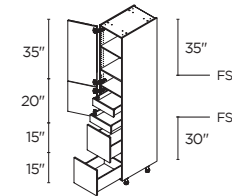

2 DOORS / 2 DRAWERS / 2 INNER DRAWERS

15" | T2D152489.5I2(L/R)
18" | T2D182489.5I2(L/R)
24" | T2D242489.5I2(L/R)

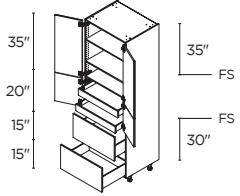

4 DOORS / 2 DRAWERS / 2 INNER DRAWERS

30" | T2D302489.5I2

89 1/2" H TALL APPLIANCE CABINETS >

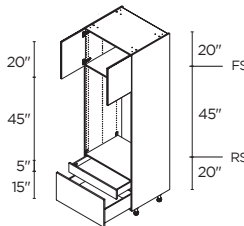

MICRO/WALL OVEN ² 2 DOORS / 2 DRAWERS

30" | TMO2D3089.5

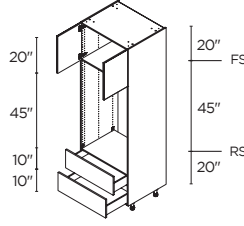

MICRO/WALL OVEN ² 2 DOORS / 2 DRAWERS

30" | TMO2DA3089.5

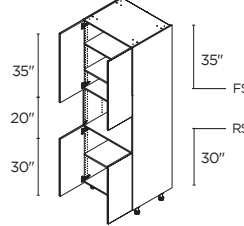

MICROWAVE ¹ 4 DOORS

30" | TM3089.5

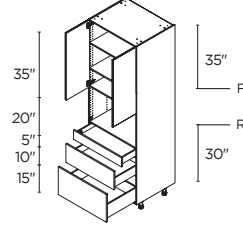

MICROWAVE ¹ 2 DOORS / 3 DRAWERS

30" | TM3D3089.5

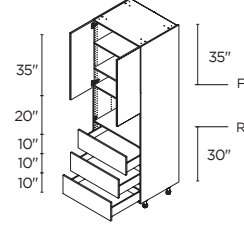

MICROWAVE ¹ 2 DOORS / 3 DRAWERS

30" | TM3DA3089.5

RS = Reinforced Shelf. FS = Fixed Shelf. **Appliance cut-out sizes:** (use of a filler is required and must be ordered separately):
¹28 1/2" width x 18 1/2" high. ²28 1/2" width x 43 1/2" high. ³28 1/2" width x 53 1/2" high. ⁴28 1/2" width x 28 1/2" high.

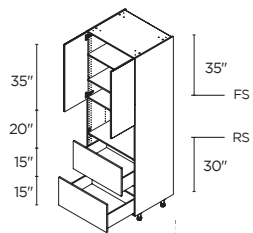

MICROWAVE ¹
2 DOORS /
2 DRAWERS
 30" | TM2D3089.5

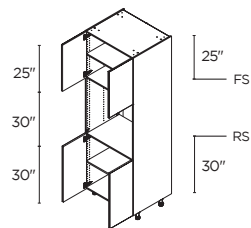

SINGLE OVEN ³
4 DOORS
 30" | TO3089.5

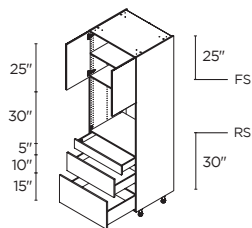

SINGLE OVEN ³
2 DOORS / 3 DRAWERS
 30" | TO3D3089.5

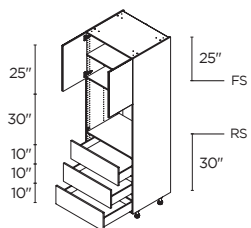

SINGLE OVEN ³
2 DOORS / 3 DRAWERS
 30" | TO3DA3089.5

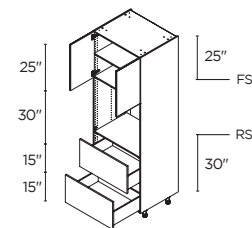

SINGLE OVEN ³
2 DOORS / 2 DRAWERS
 30" | TO2D3089.5



Lasalle

RS = Reinforced Shelf. FS = Fixed Shelf. **Appliance cut-out sizes:** (use of a filler is required and must be ordered separately):
¹28 1/2" width x 18 1/2" high. ²28 1/2" width x 43 1/2" high. ³28 1/2" width x 53 1/2" high. ⁴28 1/2" width x 28 1/2" high.

COLOUR-MATCHED ACCESSORIES

Add stylish finishing touches to your project with our choice of colour-matched panels and trims, all designed to complete your kitchen beautifully.

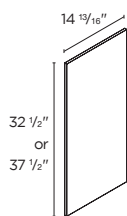

**WALL CABINET
COVER PANEL**

14 13/16"

5/8 x 32 1/2" | CP1432
5/8 x 37 1/2" | CP1437

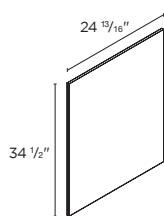

**BASE CABINET
COVER PANEL**

24 13/16"

5/8 x 34 1/2" | CP2434

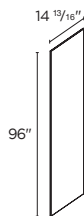

**TALL CABINET
COVER PANEL**

14 13/16"

5/8 x 96" | CP1496

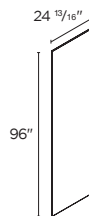

**TALL CABINET
COVER PANEL**

24 13/16"

5/8 x 96" | CP2496

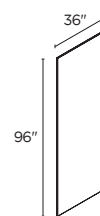

**TALL CABINET
& FRIDGE GABLE
COVER PANEL 36"**

5/8 x 96" | CP3696

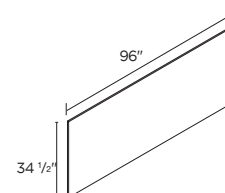

ISLAND PANEL 34 1/2"

5/8 x 96" | CP3496

Finished edges on all sides.



FILLER

3 x 5/8 x 30" | F330
3 x 5/8 x 96" | F396

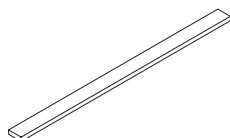

TOE-KICK

96 x 3/4 x 4 1/2" | TK96



**SQUARE EDGE
MOULDING**

Not available for Beaumont & Jolie
2 3/8 x 3/4 x 96" | SLV96



**CURVED EDGE
MOULDING**

Available for Beaumont & Jolie only
2 3/8 x 3/4 x 96" | SLV96

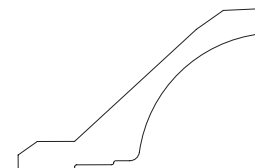

**COVE CROWN
MOULDING**

With cleat
Available for Beaumont & Jolie only
96 x 5 x 3 5/16" | CCM9

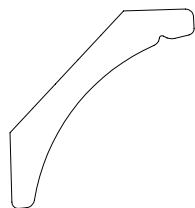

CROWN MOULDING

Without cleat
Not available for Jolie
96 x 4 x 1" | CCM96



SCRIBE MOULDING

Not available for Jolie
96 x 1/4 x 1 1/4" | SBM96



BASE MOULDING

Available for Beaumont & Jolie only
96 x 3/4 x 4 5/8" | FBM96

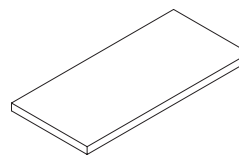

FLOATING SHELF

Not available for Cumberland
30 x 12 x 1 1/2" | FS3012

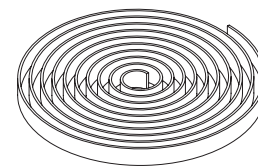

EDGE BANDING

5/8" x 35' | ET35

INTERIOR ACCESSORIES & HARDWARE

Designed to make everyday use of your kitchen a great experience, our specially designed interior accessories are made to our exacting Hugo&Borg standards. Don't forget, the Hugo&Borg range includes all the hardware and fittings you need from hinges to toe-kick clips.

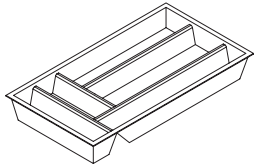

CUTLERY TRAY 15"
15 x 24" | CT15

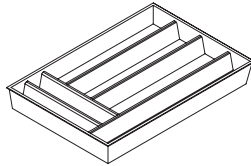

CUTLERY TRAY 18"
18 x 24" | CT18

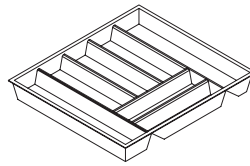

CUTLERY TRAY 24"
24 x 24" | CT24

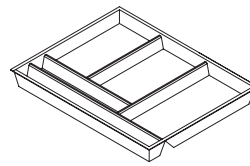

CUTLERY TRAY 30"
30 x 24" | CT30

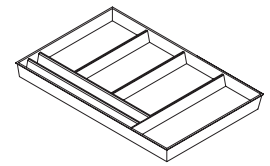

CUTLERY TRAY 36"
36 x 24" | CT36

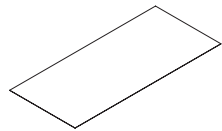

DRAWER MAT
Must be trimmed by installer
46 x 24" | DM46

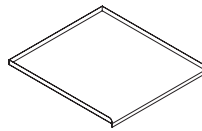

UNDER SINK MAT
30 x 24" | SBM30
36 x 24" | SBM36

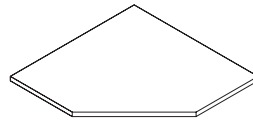

WALL CORNER SHELF 24"
24" | SHL-2424 CORNER

TOUCH-UP KIT

Lasalle & Rosemont | TUK-GW
Charlesberg | TUK-LG
Beaumont | TUK-SG
Jolie | TUK-WW

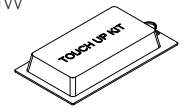

Kit includes one marker, one wax touch-up stick and one foam pad.

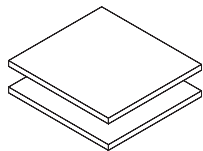

SHELIVING 14"
12 x 3/4" | SHL-1214
15 x 3/4" | SHL-1514
18 x 3/4" | SHL-1814
24 x 3/4" | SHL-2414
30 x 3/4" | SHL-3014
36 x 3/4" | SHL-3614

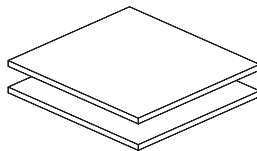

SHELIVING 24"
12 x 3/4" | SHL-1224
15 x 3/4" | SHL-1524
18 x 3/4" | SHL-1824
24 x 3/4" | SHL-2424
30 x 3/4" | SHL-3024
36 x 3/4" | SHL-3624

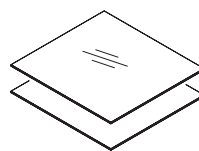

GLASS SHELVING 14"
Shipped separately
15 x 1/4" | GSHL-1514
18 x 1/4" | GSHL-1814
30 x 1/4" | GSHL-3014
36 x 1/4" | GSHL-3614

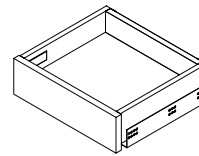

SHALLOW INNER DRAWER KIT 14"
Supplied with drawer front
15 x 3 3/8" | DSDK1514
18 x 3 3/8" | DSDK1814
24 x 3 3/8" | DSDK2414

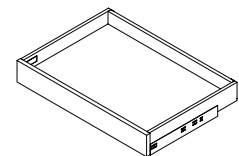

INNER DRAWER KIT 24"
Supplied with drawer front
15 x 3 3/8" | DSDK1524
18 x 3 3/8" | DSDK1824
24 x 3 3/8" | DSDK2424
30 x 3 3/8" | DSDK3024
36 x 3 3/8" | DSDK3624

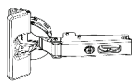

110 DEGREE HINGE
Used for standard doors
DS110HINGE



155 DEGREE HINGE
Must be used when adding interior drawers behind cabinet doors
DS155HINGE



HORIZONTAL LIFT-UP HINGE
Used to create lift-up doors
DSLHINGE



HUGO & BORG

CABINET MAKERS

Exclusive to Lowe's

www.hugoandborg.ca

Email: info@hugoandborg.ca

Tel: 1.833.283.2877

