



RONA

PLAN THE KITCHEN OF YOUR DREAMS

FROM INSPIRATION TO INSTALLATION



PLANNING YOUR KITCHEN RENOVATIONS

At first glance, renovating a kitchen seems like a complex endeavour. But don't worry! Good planning will make the work far less daunting. Mainly, you need to identify your needs, take inspiration from different kitchen models, set a budget, and find a trustworthy professional.

CLIENT INFORMATION

Name

Address

Phone number

Email address

1 COMPLETE THIS GUIDE

2 CONSULT OUR IN-STORE EXPERTS

➤ **BOOK YOUR APPOINTMENT NOW!**

1 855 RONA-123

RONA.CA/INSTALL

➤ **WHAT TO BRING IN STORE**

- ☐ Your completed planning guide
- ☐ Photos
- ☐ Other references, if possible (inspiration)

3 WE INSTALL IT FOR YOU



- Certified professionals
- 1-year labour warranty
- Flexible financing options

SIZE AND FLOW

LINEAR
WITH OR WITHOUT ISLAND

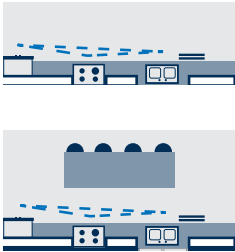

L-SHAPED
WITH OR WITHOUT ISLAND

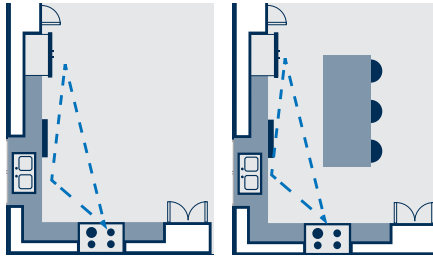

U-SHAPED
WITH OR WITHOUT ISLAND

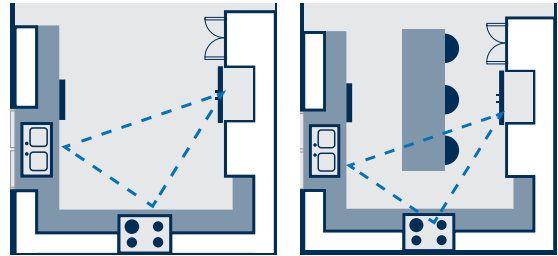

GET INSPIRED AND CHOOSE YOUR STYLE

MODERN



A clean and minimalist style. Modern and functional, a contemporary kitchen is at once elegant and welcoming. An abundance of light and high-quality materials make it prestigious and inspiring.

URBAN



Warm character, with practical dimensions perfectly suited for an active lifestyle. Noble materials like wood and granite will bring an authentic, spirited, and prosperous atmosphere. Mouldings and other details are the finishing touches that make this kitchen shine.

COTTAGE



The perfect solution for a lively and accessible kitchen. By using pre-assembled cabinets, it's easy to create something simple and charming while staying on budget..

IMPORTANT QUESTIONS TO ASK YOURSELF

Are you renovating or building from scratch ? ☐ Renovating ☐ Building

What is the approximate value of your current house ? _____ What year was your house built ? _____

How many people in the household? _____ How many cooks in the kitchen? _____

Have you completed renovation projects in the past ? ☐ Yes ☐ No

Are you changing the layout of the kitchen? ☐ Yes ☐ No

Which elements of your kitchen do you plan on changing ?

☐ Cabinets ☐ Counters ☐ Floor ☐ Paint ☐ Storage ☐ Sink

☐ Faucet ☐ Backsplash ☐ Hood ☐ Lighting ☐ Others _____

Do you plan on moving any of the following items?:

☐ Walla ☐ Drainage ☐ Doors ☐ Windows ☐ Outlets ☐ Hood

What do you like the most and the least in your current kitchen? (2 answers)

What would be the most important elements of your new kitchen?:

☐ Accent Lighting ☐ Apron Sink ☐ Cutlery Drawers ☐ Fridge Panels ☐ Glass doors
☐ Glass Shelves ☐ Island Seating ☐ Mantle Hood ☐ Matching End Panels ☐ Moldings
☐ Open Shelves ☐ Pantry ☐ Cabinets ☐ Plate Racks ☐ Pots and Pans Cabinet
☐ Pullout Spice Rack ☐ Staggered Uppers ☐ Tiered Cutlery Divider ☐ Tray Dividers ☐ Under cabinet Lighting
☐ Wine Storage

By when would you like your project to be completed ? _____

FIGURE OUT YOUR BUDGET

Did you know the cost of renovating your kitchen should be between 10% and 20% of your house's market value? If your budget is more limited, choose pre-assembled cupboards. They are less expensive, and the choices are just as interesting.

YOUR BUDGET:

\$

Do you need a financing program? ☐ Yes ☐ No

Do you have a RONAdvantages credit card? ☐ Yes ☐ No

WORK SCHEDULE

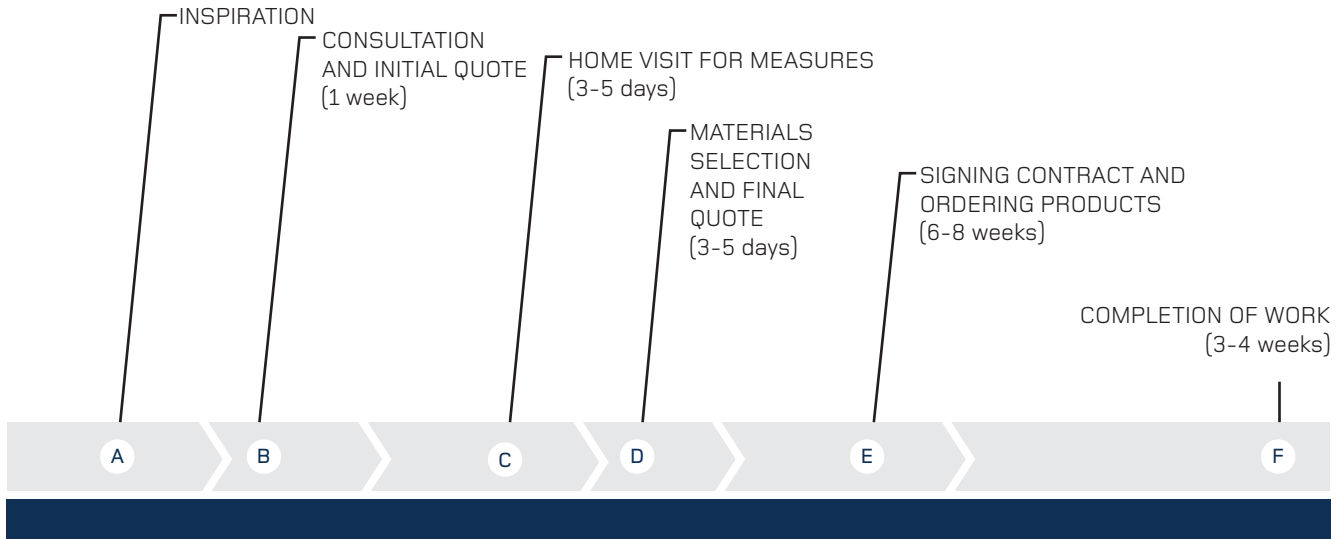

WHAT TO EXPECT

1- Do not begin any demolition or renovation work in your kitchen before your cabinets have been delivered and inspected. Missing or damaged parts may delay the installation.

2- Empty your old cupboards and drawers before the installers arrive. Remove anything that is attached to the walls and clear the counters.

3- The RONA installers will remove and replace your old cabinets and countertops, and then install the new appliances and flooring included in your project, if applicable.

4- During installation, if your installers encounter a pre-existing or hidden problem that undermines the integrity of your project, they will inform you and the store of this and will decide if the situation must be resolved before proceeding with the project. We will provide you with solutions, depending on the problem. If additional charges apply, you can make an informed choice before the work resumes.

5- If you are also buying a new counter, expect to do without a sink for a few weeks. A delay may occur between installing your cabinets and preparing, delivering and installing your counter. You can ask the installer to put in a temporary sink for an additional cost.

6- Although your installers make every effort to contain dust within the work area, it will no doubt spread to other parts of your home. We apologize for the inconvenience, while assuring you that your finished kitchen will make you forget these annoyances!

7- While your kitchen is unusable, you will temporarily need a new way to prepare meals. Consider moving your microwave oven, refrigerator and small appliances (toaster, can opener, etc.) to another room, or decide on another way to get your meals.

8- For safety reasons, please keep children and pets away from the work area.

9- Once installation is completed, the installers will do a final inspection with you to ensure that the results meet your expectations.

Thank you for choosing RONA.

CABINET SELECTION		
FEATURE	1 ST CHOICE	2 ND CHOICE
Location Perimeter, Island, Uppers, Bases (2 tone kitchen)		
Door Style Please provide the name of the door style based on the manufacturer selected		
Wood Species	<input type="checkbox"/> Maple <input type="checkbox"/> Cherry <input type="checkbox"/> Oak <input type="checkbox"/> Alder <input type="checkbox"/> Hickory <input type="checkbox"/> Birch <input type="checkbox"/> Thermofoil <input type="checkbox"/> Laminate <input type="checkbox"/> Truecolor	<input type="checkbox"/> Maple <input type="checkbox"/> Cherry <input type="checkbox"/> Oak <input type="checkbox"/> Alder <input type="checkbox"/> Hickory <input type="checkbox"/> Birch <input type="checkbox"/> Thermofoil <input type="checkbox"/> Laminate <input type="checkbox"/> Truecolor
Colour/Finish Stain, Paint, Glaze etc.		
Drawers Check all that apply	<input type="checkbox"/> Slab Drawer fronts <input type="checkbox"/> Profiled Drawer fronts <input type="checkbox"/> Wooden Drawer Boxes <input type="checkbox"/> Melamine Drawer Boxes <input type="checkbox"/> Metal Drawer Boxes	
Ceiling Height	Mounting Height Check all that apply	<input type="checkbox"/> 84" <input type="checkbox"/> 87" <input type="checkbox"/> 90" <input type="checkbox"/> 93" <input type="checkbox"/> 94½" <input type="checkbox"/> 96" <input type="checkbox"/> Other _____
Height of Uppers	<input type="checkbox"/> 30" <input type="checkbox"/> 33" <input type="checkbox"/> 36" <input type="checkbox"/> 39" <input type="checkbox"/> 41" <input type="checkbox"/> 42" <input type="checkbox"/> Other _____	
Crown Molding Name of the Crown or NA		
Soffit Fill Name of the Fill or NA		
Light Valance Name of the Valance or NA		
Furniture Base Molding For Island / Peninsula or NA		

COUNTERTOP SELECTION		
Material	<input type="checkbox"/> Granite <input type="checkbox"/> Laminate <input type="checkbox"/> Quartz <input type="checkbox"/> Corian <input type="checkbox"/> Solid Surface	
Colour		Edge profile

SINK SELECTION	
Detail	<input type="checkbox"/> Single <input type="checkbox"/> Double <input type="checkbox"/> Drop In <input type="checkbox"/> Under Mount <input type="checkbox"/> Apron/Farm <input type="checkbox"/> Integral <input type="checkbox"/> Other _____

MEASURING YOUR KITCHEN

Measurements are required at the time of your design appointment.
Please complete this page as accurately as possible.
This will allow us to create a design for your room. Please measure in inches.

Example of elevation

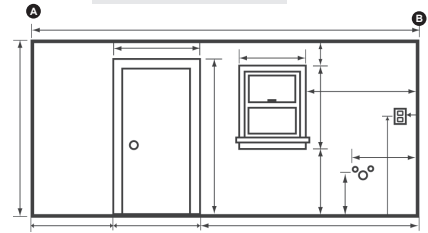

DOOR ELEVATIONS

Record door measurements and locate each on your Floor Plan. Mark the width from the outside of the trim to the opposite outside of the trim.

DOOR	W X H	
A		
B		
C		
D		

WINDOW ELEVATIONS

Record window measurements and locate each on your Floor Plan. Mark the width from the outside of the trim to the opposite outside of the trim.

WINDOW	Floor to Trim	W X H	
A			
B			
C			
D			

WALL HEIGHT AND BULKHEAD MEASUREMENTS

Record wall height (from floor to ceiling) and bulkhead (from floor to ceiling). Locate bulkheads on Floor Plan.

Ceiling/Bulkhead Measurements	
Ceiling H: _____	Floor to Bulkhead H: _____
Bulkhead A	W: x D: x H:
Bulkhead B	W: x D: x H:
Bulkhead C	W: x D: x H:

COUNTERTOP HEIGHT

Record countertop height. First, from the floor to the top of the countertop. Then from the floor to the top of the countertop backsplash.

COUNTERTOP	Measurements
Floor to top of countertop	H:
Floor to top of countertop backsplash	H:

APPLIANCES – APPLIANCE MEASUREMENTS ARE REQUIRED AT THE TIME OF YOUR DESIGN APPOINTMENT.

APPLIANCE	DIMENSIONS	DETAILS	MODEL #
FRIDGE	W: x D: x H:	<input type="checkbox"/> Left <input type="checkbox"/> Right <input type="checkbox"/> Side by side <input type="checkbox"/> French door <input type="checkbox"/> Top freezer <input type="checkbox"/> Bottom freezer <input type="checkbox"/> None	
DISWASHER	W: x D: x H:	<input type="checkbox"/> Portable <input type="checkbox"/> Built-in <input type="checkbox"/> None	
MICROWAVE	W: x D: x H:	<input type="checkbox"/> Shelf <input type="checkbox"/> Countertop <input type="checkbox"/> Built-in <input type="checkbox"/> None	
SINK	W: x D: x H:	<input type="checkbox"/> Single <input type="checkbox"/> Double	
OVEN	W: x D: x H:		
STOVETOP	W: x D: x H:	<input type="checkbox"/> Gas <input type="checkbox"/> Electric <input type="checkbox"/> None	
HOOD	W: x D: x H:		
CELLIER	W: x D: x H:		
OTHER	W: x D: x H:		

PLAN

SAMPLE KITCHEN SKETCH FOR CABINETS & COUNTERTOPS

- Draw the layout of your entire kitchen including cabinets, countertops, doors, windows, heat registers etc.
- Measure the sink window wall first.
- Start in the corner and measure (in inches) to the edge of the window trim.
- Record locations of existing sink, open cabinet space beneath the sink, stove/slide-in range, cooktop, refrigerator, dishwasher, range hoods.
- Record locations of electrical outlets and switches.
- Record the measurement from the wall to the sink centre.
- Measure windows & doors from outside trim to outside trim. Record measurements in the boxes above, as instructed.
- Show floor vents on floor plan. Measure distance of each vent from the wall.
- Measure from the wall in the corner to the end of the countertop in both directions.
- Measure all other countertops.
- Record any wall areas that you think may interfere with the countertop (ex. pipe chase, bowed walls, chimney, etc.)

Example of plan

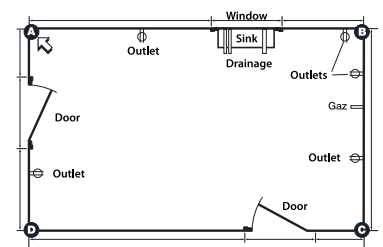

Scale: 1 large square = 12" 1 small square = 3"

SKETCH A FLOOR PLAN OF THE ROOM.

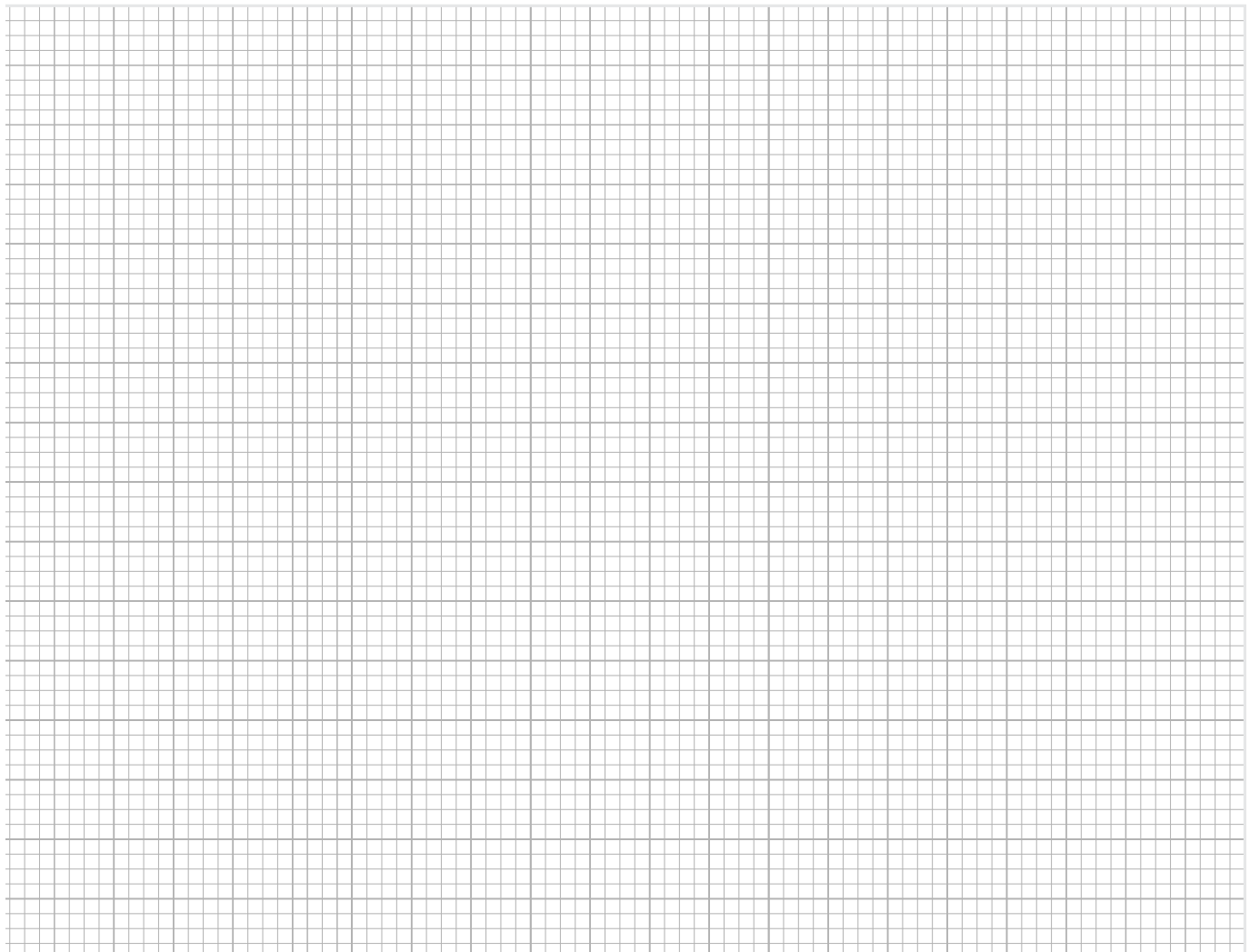

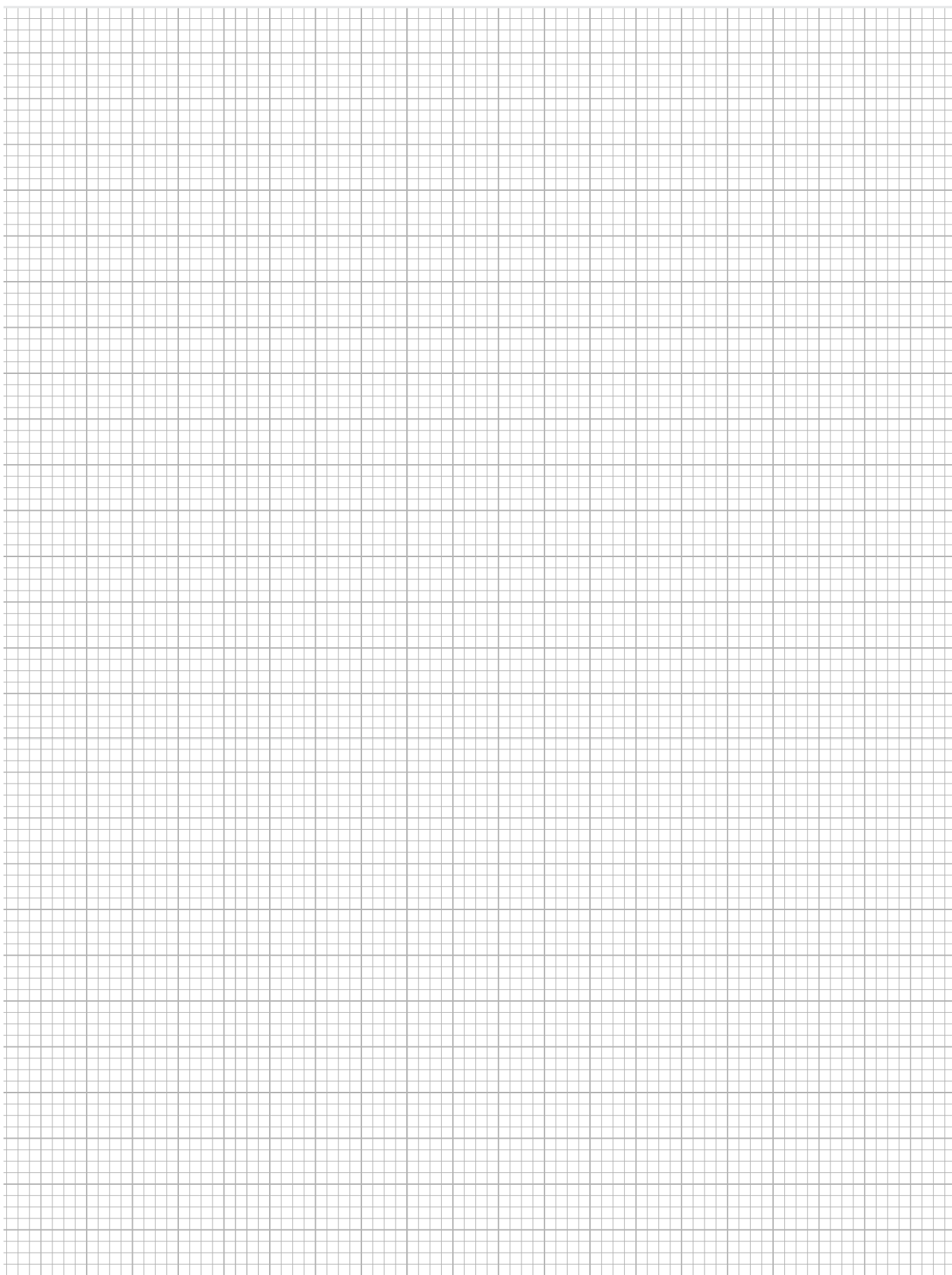

KEY STEPS FOR A SUCCESSFUL PROJECT

1

Complete the planning guide and bring it in-store with you (expect +/- 2h).

2

Consult our experts and receive a detailed project proposition with 3D renderings.

3

Let us do the work for you.



WE INSTALL
CERTIFIED CONTRACTORS.
GUARANTEED WORK.

START YOUR PROJECT NOW
1 855 RONA-123
OR RONA.CA/INSTALL

DREAM PROJECT DREAM PAYMENTS

WE FINANCE
YOUR PROJECT
0% INTEREST DURING
2 MONTHS FOLLOWED BY:

36



EQUAL MONTHLY
INSTALMENTS[§]
STARTING AT 6% INTEREST



ANY TIME,
GET UP TO

2x

THE AIR MILES[®]
REWARD MILES[†]

ANNUALLY,
GET UP TO

5%

CASH BACK
IN RONA
GIFT CARD[†]

Build Up Plan conditions: Eligibility subject to Fédération des caisses Desjardins du Québec ("the Federation") approval. Certain conditions apply. The Build Up Plan offer may end or may be changed without notice. Terms and conditions available in store or on www.renodelpot.com/en/build-up-plan. **Financing program conditions:** Eligibility subject to Fédération des caisses Desjardins du Québec approval. All annual interest rates indicated are subject to change. The financing offer is available on a RONA, Rêno-Dépôt and RONA Visa Desjardins credit cards and other credit card issued by the Federation ("the Card"). **§**The "Multiple purchases through equal payments" offer or "Multi-purchase Plan" allows the customer to make multiple purchases over a period of two months («the deferral period») for a specific project, without making any payment nor incurring interest during this period. At the end of the deferral period, the balance of the multiple purchases is payable in 24 or 36 equal and consecutive monthly instalments, accordingly to the plan registered during the deferral period, at an annual interest of 13.5% if the balance is less than \$2,500 or, if the balance is equal to or greater than \$2,500, at an annual interest rate of 4.0% (for transactions posted to the account with the 24 instalments plan during the deferral period) or at 6% (for transactions posted to the account with the 36 instalments plan during the deferral period). Equal monthly instalments are included in the minimum payment due on the card. **Other conditions:** If the minimum payment due is not paid in full by the due date, the annual interest rate of not more than 19.9% on the card applies to the unpaid equal monthly instalment, including monthly instalment. There is a 21-day, interest-free grace period on the card from the date the monthly statement is mailed or from the date it is made available in electronic format to settle the account without paying interests. Minimum card payment is 5% of the total on: (i) the balance shown on the account statement for the previous period; (ii) interests on purchases and monthly instalments that have not been paid on the due date for the previous period; (iii) regular purchases during the statement period; (iv) monthly instalment(s) relative to Multiple purchases through equal payment or Multi-Purchase Plan for the statement period; (v) deferred payment purchases due on the statement date; and (vi) past due amounts and any other amount set out in the card contract. Other conditions can be applied, refer to the card contract. See details in store. **®**TM Trademarks of AM Realities Limited Partnership used under license by RONA.

	ANNUAL COST		COST FOR 30 DAYS	
ANNUAL INTEREST RATE	Average daily balance		Average daily balance	
	\$100	\$500	\$100	\$500
19.9%	\$19.90	\$99.50	\$1.64	\$8.18
21.9%	\$21.90	\$109.50	\$1.80	\$9.00
24.9%	\$24.90	\$124.50	\$2.05	\$10.23

The annual interest rate may apply to regular purchases, equal payment financing, deferred payment financing, deferred equal payment financing or multiple purchases by equal payment financing.