

SIDEBOARD CONSOLE

CONSTRUCTION PLAN



Difficulty level: TT | MODERATE

Completion time: 8 hours

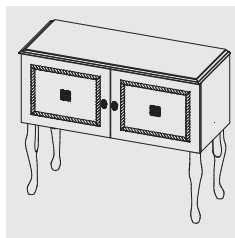
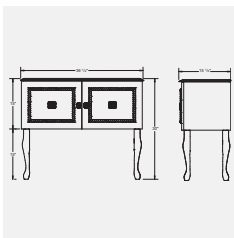

SIDEBORD CONSOLE

This buffet-style console cabinet measuring 30" high by 36 1/2" wide and 15 1/4" deep is made entirely from MDF, with the exception of the mouldings and legs, which are wood.

A sideboard like this is not only practical but also looks classic and elegant painted white and decorated with mouldings and arabesques. It can easily be personalized by painting it the colour(s) of your choice to match your decor.



TOOLS AND MATERIALS NEEDED

TOOLS

- > Table saw
- > Mitre saw
- > Driver drill
- > Pneumatic nailer
- > Router with Freud 38-352 bit
- > Countersink drill bit for No. 8 screws
- > 1/8" bit
- > Forstner bit
- > Square
- > Pencil
- > Measuring tape

MATERIALS

- > 1 sheet MDF, 5/8" x 48" x 96"
- > 4 Queen Anne table legs, 2 1/2" x 15"
- > 1 length half-round rope moulding, 1/2" x 96"
- > 2 square arabesques, 2" x 2"
- > 2 door knobs
- > 4 concealed hinges, with screws
- > 2" No. 8 screws
- > Carpenter's glue
- > 18-gauge 1 1/2" finishing nails for pneumatic nailer
- > Wood filler
- > Primer
- > Paint

Routers

The router is a motorized tool that can be equipped with a wide variety of cutters, or bits, making it extremely versatile. There is a router bit for every type of woodworking project, from making mouldings to carving grooves (e.g. for inserting drawer bottoms or cabinet door panels), giving a more professional-looking finish to the edges of pieces of stock (boards, shelves, tables), planing surfaces and even making dovetail joints. Router bits are often sold in sets and usually come with illustrations of the patterns that they can cut.

Depending on the model of router and type of work involved, the user either moves the router along the fixed material (e.g. to follow curves) or moves the material itself along a fixed router table (e.g. to carve grooves). A number of routers are designed to be used either way and can be fastened upside down under a router table.

MDF

MDF is a versatile material that makes it easy to build strong, sturdy and affordable furniture. It is advisable to always glue the parts together with wood glue before fastening them with nails or screws. If the nails or screws do not provide enough strength, use clamps to hold the assembly together while the glue dries.

Screw fastening:

Always drill pilot holes using a countersink bit, with the pieces in their final assembled position. This will prevent the MDF from buckling or splitting under the torque of the screws. In one motion, the countersink bit bores a hole for the body of the screw as well as a cavity to conceal the screw head. You can use a driver-drill to do this, but it is advisable to finish tightening the screws with a manual screwdriver to prevent the driver-drill's speed and force from damaging the MDF and weakening the screw's grip.

Nail fastening:

For some projects it is best to use finishing nails. In such cases, using a pneumatic nailer will get the job done more quickly and easily, and the nails will hardly show.

SIDEBOARD CONSOLE

BEFORE ASSEMBLY

CUTTING LIST

Sand the edges smooth as needed.

MDF 5/8", 48" x 96"

PIECES	QUANTITY	WIDTH (")	LENGTH (")
A TOP	1	15 1/4	36 1/2
B BASE	1	14	34 3/4
C BACK	1	13 3/8	34 3/4
D DOOR STOP	1	1/2	34 3/4
E SIDE	2	14	14 3/8
F DOOR	2	14 1/4	17 15/16

Half-round rope moulding, 1/2" x 96"

PIECES	QUANTITY	LENGTH (")	ANGLE (°)
G HORIZONTAL MOULDING	4	13 15/16	45
H VERTICAL MOULDING	4	10 1/4	45

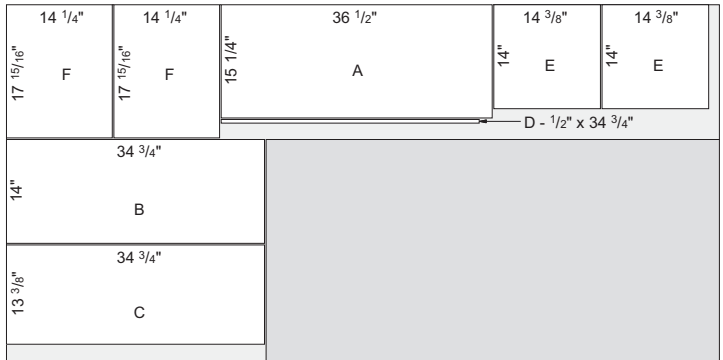

The ends of the rope moulding must be cut at 45°.

ELEVATIONS

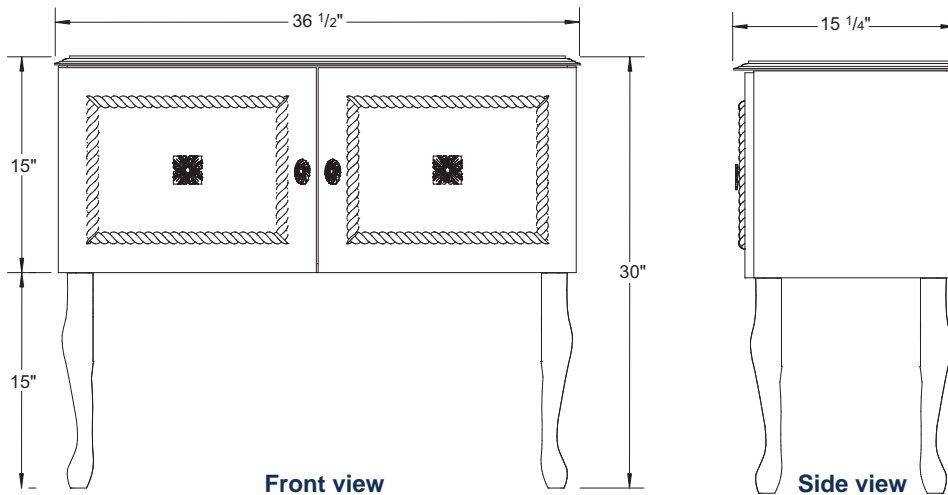

PREPARATION

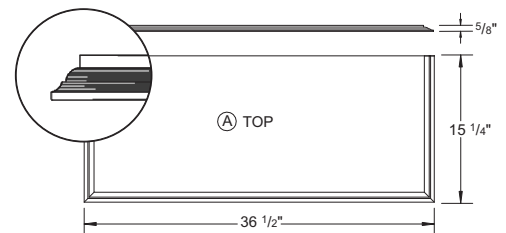
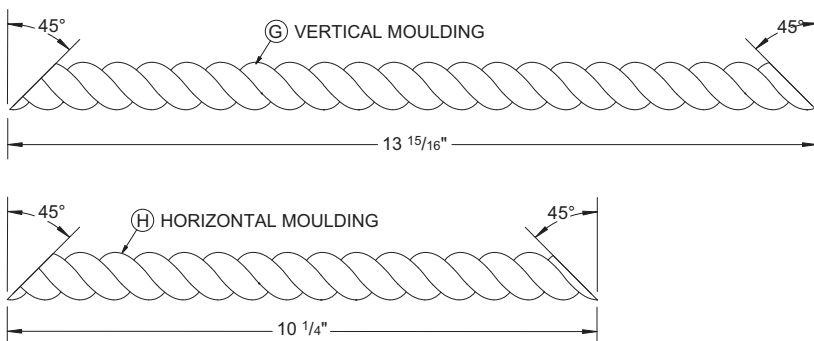

Top A: Shape the sides and the front with a router fitted with a Freud 38-352 bit.

Decorative moulding: Cut moulding G to 13 15/16" and moulding H to 10 1/4". Each end must be cut at a 45° angle.

SIDEBOARD CONSOLE

PREPARATION (CONT'D)

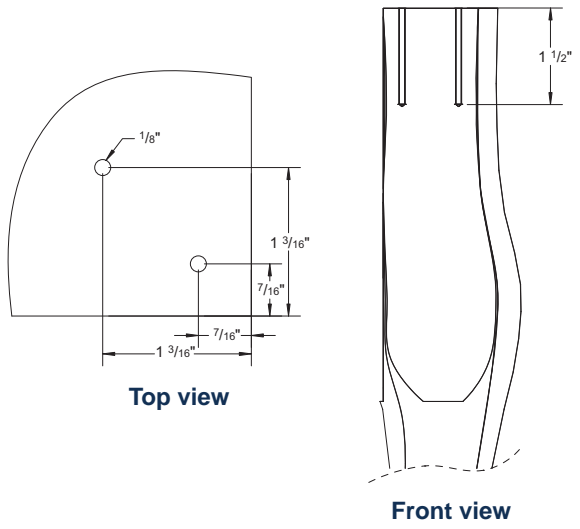
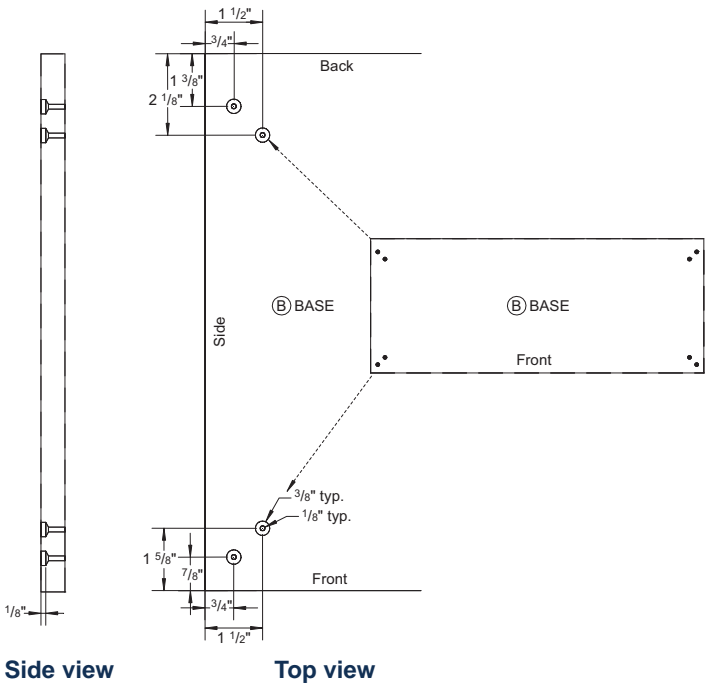

Base B: Bore pilot holes in the corners with the countersink bit according to the measurements shown in the illustration. It is important to measure very accurately. The countersunk part of the holes should be 1/8" deep.

Legs: Drill the holes in the top with the 1/8" bit to a depth of 1 1/2", following the exact measurements shown in the illustration. Make sure you hold the drill perfectly vertical when boring down into the wood.

ASSEMBLY

All parts of the sideboard console, including the legs, must be glued before fastening the nails or screws. The mouldings and arabesques only need to be glued.

- 1 Glue and screw the legs to base B with the 2" screws.
- 2 Glue and nail sides E to base B. The bottom ends of sides E must be flush with the underside of B.
- 3 Glue and nail back C between sides E. The bottom end of back C must rest on the top side of base B.
- 4 Glue and nail door stop D between sides E. The door stop must be flush with the top ends and the front of sides E.

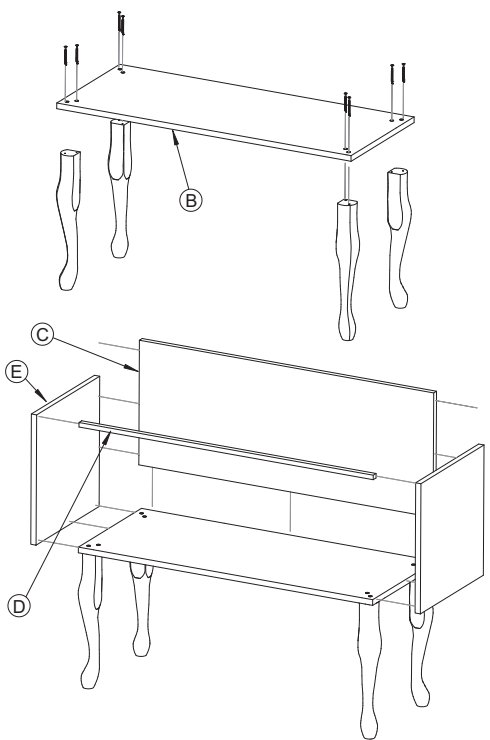

SIDEBOARD CONSOLE

ASSEMBLY (CONT'D)

- 5 Nail top A onto the console. The sides of A must overlap sides E by $\frac{1}{4}$ " and its back must be flush with back C.



- 6 Bore a hole $\frac{1}{8}$ " in diameter, 1" from the side and $7\frac{1}{8}$ " from the top of each door.

- 7 Glue the mouldings and arabesques in the centre of the doors. If you wish, you can change the layout of the arabesques or add more to make your own pattern. Screw the door knobs into the holes.

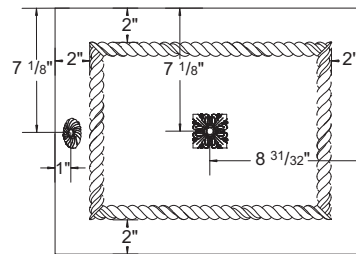

1 arabesque

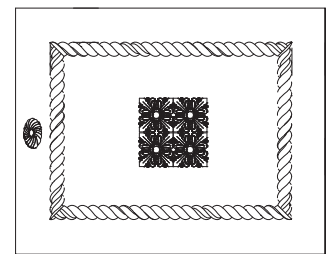

4 arabesques

- 8 Mark the positions of the hinges on the doors, $2\frac{1}{2}$ " from the top and bottom, using the manufacturer's template.

- 9 Using the drill with a suitably sized Forstner bit, bore the holes in the doors to accommodate the hinges. Be careful not to bore right through the wood; the holes must be made to the depth recommended by the manufacturer.

- 10 Fill the nail holes in the MDF using a suitable filler.

- 11 Apply a coat of primer, then paint the dresser and doors.

- 12 Screw the hinges into the hinge holes in the doors.

- 13 Place one of the doors up against the console, in the open position, and mark the position of the hinge mounting plates on the inside of the console.

- 14 Screw the hinge mounting plates over these marks, fasten the hinges to the plates, and adjust.

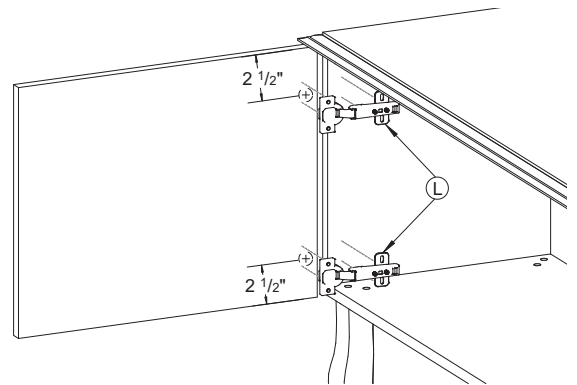

This MDF console can be used as a sideboard, drinks cabinet, games chest or whatever you wish. An attractive and stylish way to create more storage space!